

MICROFILM

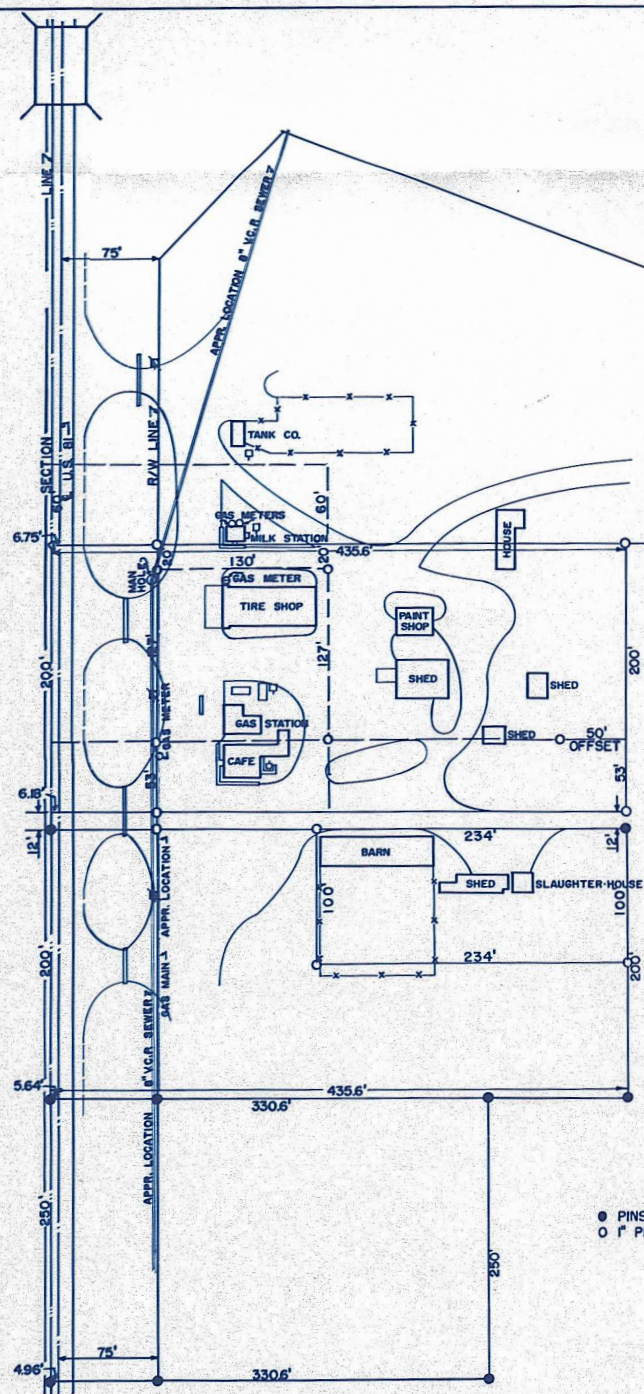

1/16<sup>th</sup> LINE BET. N & S 1/2  
SW SEC. 29-19-3



SCALE 1" = 50'

McPHERSON COUNTY HIGHWAY DEPARTMENT  
FRANCIS D. WAGNER - COUNTY ENGINEER

A SURVEY IN THE SOUTH HALF  
SW 1/4 SECTION 29-T19S-R3W  
McPHERSON COUNTY, KANSAS.

MAY 21, 1959