

DESCRIPTION:
PARCEL 1

A portion of the Southeast Quarter of Section 28, Township 20 South, Range 3 West of the 6th Principal Meridian, McPherson County, Kansas described as follows:

Commencing at the Southwest corner of said Southeast Quarter; thence on a NAD 83 Kansas South Zone bearing of North 88°47'59" East on the South line of said Southeast Quarter a distance of 440.18 feet to the point of beginning; thence North 01°12'01" West perpendicular to said South line a distance of 758.40 feet; thence South 84°29'43" East a distance of 205.19 feet; thence South 52°53'51" East a distance of 58.92 feet; thence South 79°39'57" East a distance of 218.35 feet; thence South 05°30'03" East a distance of 318.63 feet; thence South 06°10'06" West a distance of 339.34 feet to said South line; thence South 88°47'59" West on said South line a distance of 444.34 feet to the point of beginning.

Containing **7.676 Acres** and subject to a road right of way easement across the South 33.00 feet thereof, and any other easements or restrictions of record.

PARCEL 2

A portion of the Southeast Quarter of Section 28, Township 20 South, Range 3 West of the 6th Principal Meridian, McPherson County, Kansas described as follows:

Beginning at the Southwest corner of said Southeast Quarter; thence on a NAD 83 Kansas South Zone bearing of North 00°45'34" West on the West line of said Southeast Quarter a distance of 2645.48 feet to the Northwest corner of said Southeast Quarter; thence North 88°56'09" East on the North line of said Southeast Quarter a distance of 508.31 feet to the centerline of Dry Turkey Creek; thence following said centerline of Dry Turkey Creek for the next 10 courses:

thence South 12°53'31" East a distance of 176.53 feet;
thence South 47°39'42" West a distance of 226.29 feet;
thence South 01°29'05" East a distance of 339.16 feet;
thence South 12°42'37" East a distance of 217.97 feet;
thence South 32°10'16" West a distance of 341.60 feet;
thence South 04°17'23" West a distance of 80.62 feet;
thence South 24°36'54" East a distance of 257.33 feet;
thence South 03°20'55" East a distance of 503.93 feet;
thence South 36°32'05" East a distance of 117.43 feet;
thence North 60°40'32" East a distance of 75.28 feet;

thence departing said centerline of Dry Turkey Creek South 01°12'01" East perpendicular to the South line of said Southeast Quarter a distance of 605.40 feet to said South line; thence South 88°47'59" West on said South line a distance of 440.18 feet to the point of beginning.

Containing **22.923 Acres** and subject to a road right of way easement across the South 33.00 feet thereof, and any other easements or restrictions of record.

PARCEL 3

A portion of the Southeast Quarter of Section 28, Township 20 South, Range 3 West of the 6th Principal Meridian, McPherson County, Kansas described as follows:

Commencing at the Southwest corner of said Southeast Quarter; North 88°47'59" East on the South line of said Southeast Quarter a distance of 884.52 feet to the point of beginning; thence North 06°10'06" East a distance of 339.34 feet; thence North 05°30'03" West a distance of 318.63 feet; thence North 79°39'57" West a distance of 218.35 feet; thence North 52°53'51" West a distance of 58.92 feet; thence North 84°29'43" West a distance of 205.19 feet; thence South 01°12'01" East a distance of 153.00 feet to the centerline of Dry Turkey Creek; thence following said centerline of Dry Turkey Creek for the next 10 courses:

thence South 60°40'32" West a distance of 75.28 feet;
thence North 36°32'05" West a distance of 117.43 feet;
thence North 03°20'55" East a distance of 503.93 feet;
thence North 24°36'54" West a distance of 257.33 feet;
thence North 04°17'23" East a distance of 80.62 feet;
thence North 32°10'16" East a distance of 341.60 feet;
thence North 12°42'37" West a distance of 217.97 feet;
thence North 01°29'05" West a distance of 339.16 feet;
thence North 47°39'42" East a distance of 226.29 feet;
thence North 12°53'31" West a distance of 176.53 feet to the North line of said Southeast Quarter;

thence departing said centerline of Dry Turkey Creek North 88°56'09" East on said North line a distance of 2119.79 feet to the Northeast corner of said Southeast Quarter; thence South 00°58'21" East on the East line of said Southeast Quarter a distance of 2639.18 feet to the Southeast corner of said Southeast Quarter; thence South 88°47'59" West on the South line of said Southeast Quarter a distance of 1753.43 feet to the point of beginning.

Containing **129.117 Acres** and subject to road right of way easements across the South and East 33.00 feet thereof, and any other easements or restrictions of record.

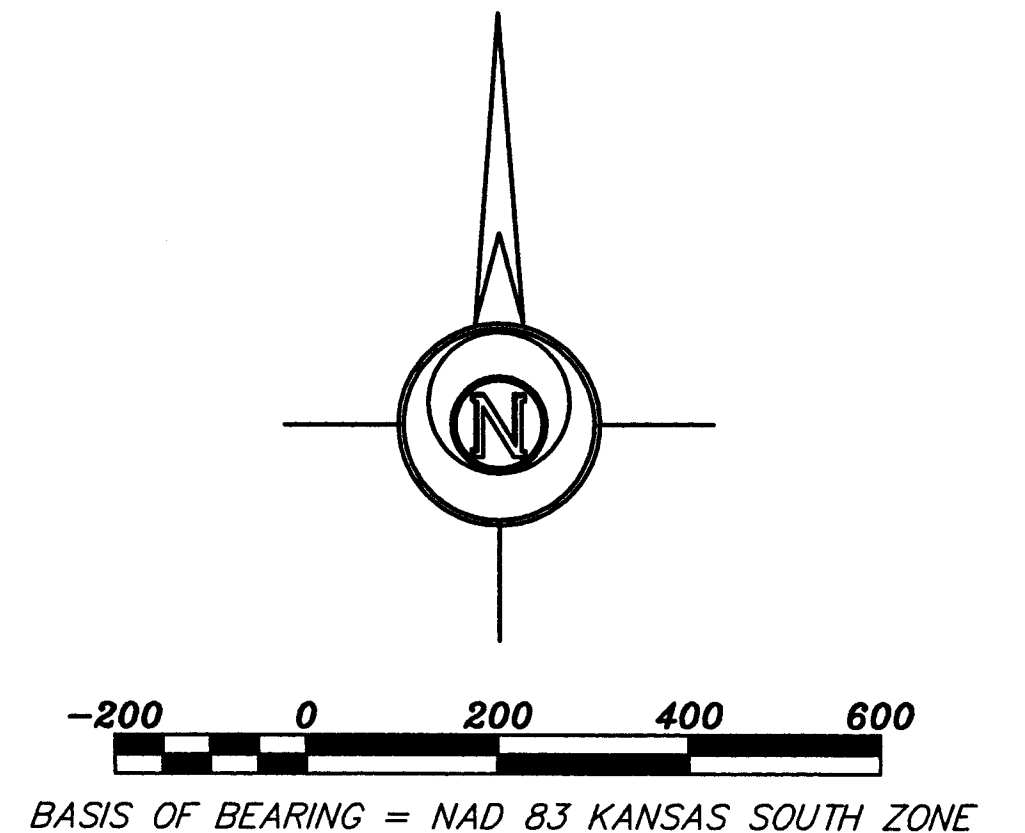

SURVEYOR'S CERTIFICATE:
I hereby certify this plot to be a true, correct and complete representation of the property described hereon, as surveyed under my supervision, this 11th day of December, 2017.

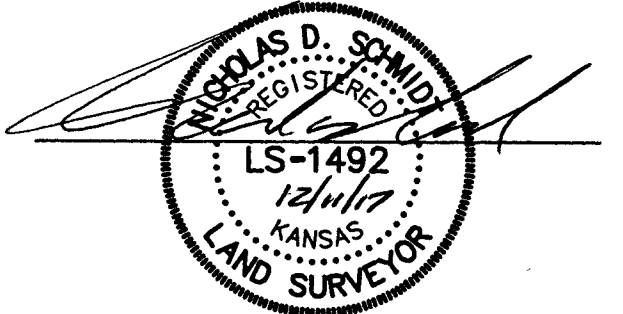

Prepared For:		Description:	
FOUR SEASONS REALTORS		A PORTION OF THE SE 1/4 SECTION 28, T20S, R03W MCPHERSON COUNTY, KANSAS	
Prepared By:		Garber Surveying Service, P.A.	
GSS		HUTCHINSON (Main Office) 2908 North Plum St. 67502 Ph. 620-665-7032 Fax 620-663-7401 MCPHERSON (Branch Office) 115 East Marlin 67460 Ph. 620-241-4441 Fax 620-241-4458 NEWTON (Branch Office) 511 North Poplar St. 67114 Ph. 316-283-5053 Fax 316-283-5073	
Drawn By: KDJ	Scale: 1"=200'	Date of Field Work: December 5, 2017	Job No:
Checked By: NDS	Date: 12/11/2017	Sheet 1 of 1 Sheet(s)	G2017-770