

- LEGEND**
- Sectional Monument Found
 - Section Monument Set (5/8" x 24" Iron Rebar w/G.S.S. Cap)
 - 5/8" x 24" Iron Rebar Set w/G.S.S. Cap
 - (C) - Calculated
 - (M) - Measured
 - P.O.C. - Point of Commencement
 - P.O.B. - Point of Beginning

DESCRIPTION:
A portion of the South Half of the North Half of the Northeast Quarter of Section 28, Township 20 South, Range 3 West of the 6th Principal Meridian, McPherson County, Kansas more particularly described as follows:

Commencing at the Northeast Corner of the Northeast Quarter of Section 28, Township 20 South, Range 3 West of the 6th Principal Meridian; thence on a Kansas State Plane South Zone bearing of South 00°58'00" East along the East line of said Northeast Quarter 984.50 feet to the point of beginning, being 324.71 feet South of the Northeast corner of the South Half of the North Half of said Northeast Quarter; thence continuing South 00°58'00" East along the East line of said Northeast Quarter, 335.08 feet to the Southeast corner of the North Half of said Northeast Quarter; thence South 88°59'31" West along the South line of the North Half of said Northeast Quarter 650.00 feet; thence North 00°58'00" West parallel with the East line of said Northeast Quarter 335.08 feet; thence North 88°59'31" East parallel with the South line of said Northeast Quarter 650.00 feet to the point of beginning containing **5.000 Acres**, subject to a road right of way easement across the East 33.00 feet thereof and any other easements of record.

SURVEYOR'S CERTIFICATE:
I hereby certify this plat to be a true, correct and complete representation of the property described hereon, as surveyed under my supervision, this 8th day of July, 2011.

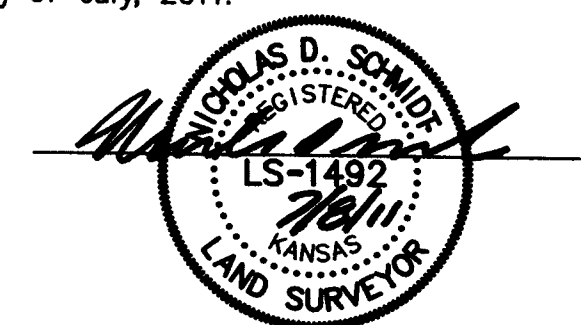

Prepared For: CHRISTOPHER BLAKE		Description: A PORTION OF THE N 1/2 OF THE NE 1/4 SEC. 28, T20S, R3W McPHERSON COUNTY, KS	
Prepared By: GSS		Garber Surveying Service, P.A. 2908 North Plum St. Hutchinson, Kansas 67502 Phone (620) 665-7032 • FAX (620) 663-7401 Phone (316) 283-5053 • FAX (316) 283-5073	
Drawn By: KLL	Scale: 1"=200'	Date of Field Work: July 1, 2011	Job No:
Checked By: NDS	Date: 07/08/2011	Sheet 1 of 1 Sheet(s)	G2011-316