

**SURVEYOR'S CERTIFICATE:**

I hereby certify this plat to be a true, correct and complete representation of the property described hereon, as surveyed under my supervision, this 25th day of September, 2023.

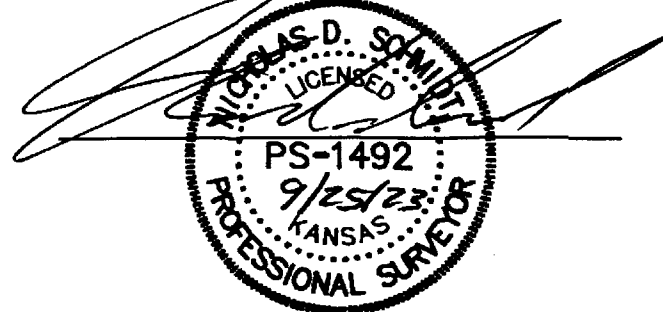

**LEGEND**

- △ - Sectional Monument Found
- ▲ - Section Monument Set (5/8" x 24" Iron Rebar w/G.S.S. Cap)
- - 5/8" x 24" Iron Rebar Set w/G.S.S. Cap
- WW - Water Well
- (C) - Calculated
- (M) - Measured
- (PS) - Previous Survey Surveyor's Record Book A, Page 364, Duval 7/2/1888
- (PS) - Previous Survey GSS Project #G2014-403
- (GLO) - General Land Office
- P.O.B. - Point of Beginning

**Prepared For:**

**JESSE KOEHN**

**Description:**

**A PORTION OF THE NE 1/4  
SECTION 26, T18S, R2W  
MCPHERSON COUNTY, KANSAS**

**Prepared By:**

**Garber Surveying Service, P.A.**



**HUTCHINSON**  
2908 North Plum St. 67502  
PH. 620-665-7032  
(Main Office)

**BRANCH OFFICES:** MANHATTAN Ph. 785-320-4810  
MCPHERSON Ph. 620-241-4441 NEWTON Ph. 316-283-5053  
SALINA Ph. 785-404-6302 WICHITA Ph. 316-260-9933

**Drawn By:** KLL

**Scale:** 1"=200'

**Date of Field Work:** September 13, 2023

**Job No:**

**Checked By:** NDS

**Date:** 09/25/2023

**Sheet 1 of 1 Sheet(s)**

**G2023-738**