

Section 25, Township 20 South, Range 2 West
Lonetree Township, McPherson Kansas

2641.36' 89°11'10" AZM. ASSUMED CM

NW Cor. Found 5/8 rebar, origin unknown.
At intersection 23rd and Commanche Rd.
45.9' NE to powerpole
57.8' SW to telephone riser

N1/4 Cor. Found Railroad spike, origin unknown.
Centerline of hedge row extended North
29.2' N to T-post in concrete
42.5' NE to spike in powerpole

W1/4 Cor. Found 5/8 bar, Origin Griffis
Centerline hedge row extended to West
27.2' NW to spike in tree
43.8' NE to spike in powerpole

E1/4 Cor. Found 5/8" bar, Origin Griffis
Centerline hedge row extended to East
29.1' WNW to spike in powerpole
29.4' E to spike in tree

SW cor. Found 5/8" bar, Origin Griffis
52.3' NW to spike in powerpole
44.4' NE to spike in powerpole
61.1' NE to top tel. riser

S1/4 Cor. Found 1/2" bar, Origin Griffis
In line with remaining trees of hedge row S
2622.34' East of SE cor. Found
5265.72' S. of N1/4 cor. Found

NW Cor.

N1/4 Cor.
30'

660.34' C

E1/2 E1/2

NW1/4

NE1/4

179°36'47" C
2629.67'

2632.94' C

2632.15' 89°31'03" C

658.04' C

658.04' C

2657.82' C

W 1/4 Cor.

(624.03' RC
88°21'46" RC

1315.49' C

Home Tract

Centerline Road

SW1/4

E1/2

5265.72' 359°52'32" CM

SE1/4

5236.18' 359°40'05" AZM. CM

2618.56' 359°39'32" AZM CM

2613.16' C
359°46'01" AZM

Sw Cor.

2622.34' 89°16'51" CM

S 1/4 Cor.

N

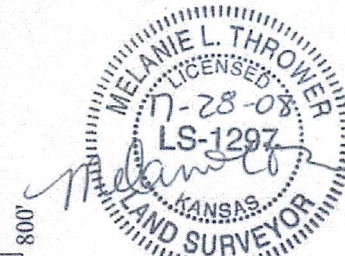

800'
1"=800'

- Corners set previous surveys
- Set 5/8" x 24" bar with Surveyor ID cap
(Note- 5' Green and White Metal T post with flagging was set at all corners this survey at off road boundary locations per client request)

I, Melanie L. Thrower, Licensed Land Surveyor in the State of Kansas certify that on July 28, 2008, I located monuments from surveys of J.L. Griffis dated Oct. 27th 1975, and Doug Rathbone dated May 9, 1994 as shown and placed monuments as shown. The above plat is a true exhibit of said survey as far as it is known by me.

Client: Don & Elaine Ratzlaff