

- LEGEND**
- △ - Sectional Monument Found
 - ▲ - Section Monument Set (5/8" x 24" Iron Rebar w/G.S.S. Cap)
 - - 5/8" x 24" Iron Rebar Set w/G.S.S. Cap
 - (C) - Calculated
 - (M) - Measured
 - (GLO) - General Land Office
 - P.O.B. - Point of Beginning
 - P.O.C. - Point of Commencement

DESCRIPTION:
PARCEL 1

A portion of the Southwest Quarter of Section 25, Township 18 South, Range 3 West of the 6th Principal Meridian, McPherson County, Kansas described as follows:

Commencing at the Southwest corner of said Southwest Quarter; thence on a NAD 83 Kansas South Zone bearing of North 01°01'22" West on the West line of said Southwest Quarter a distance of 314.39 feet to the point of beginning; thence continuing North 01°01'22" West on the West line of said Southwest Quarter a distance of 637.34 feet; thence South 88°12'49" East a distance of 734.99 feet; thence South 01°01'22" East parallel with said West line a distance of 612.63 feet; thence South 89°51'35" West parallel with the South line of said Southwest Quarter a distance of 734.19 feet to the point of beginning.

Containing 10.533 Acres and subject to a road right of way easement across the West 33.00 feet thereof, and any other easements or restrictions of record.

PARCEL 2

A portion of the Southwest Quarter of Section 25, Township 18 South, Range 3 West of the 6th Principal Meridian, McPherson County, Kansas described as follows:

Commencing at the Southwest corner of said Southwest Quarter; thence on a NAD 83 Kansas South Zone bearing of North 01°01'22" West on the West line of said Southwest Quarter a distance of 305.25 feet (Record) to the point of beginning; thence continuing North 01°01'22" West on the West line of said Southwest Quarter a distance of 9.14 feet; thence North 89°51'35" East parallel with the South line of said Southwest Quarter a distance of 734.19 feet; thence South 01°01'22" East parallel with said West line a distance of 314.39 feet to the South line of said Southwest Quarter; thence South 89°51'35" West on said South line a distance of 449.56 feet to a point 284.63 feet (Record) East of the Southwest corner of said Southwest Quarter; thence North 01°01'22" West parallel with said West line a distance of 305.24 feet (Record); thence South 89°51'35" West parallel with said South line a distance of 284.63 feet to the point of beginning.

Containing 3.304 Acres and subject to road right of way easements across the South 30.00 feet and West 33.00 feet thereof, and any other easements or restrictions of record.

Proposed 40' Waterline Easement

A portion of the Southwest Quarter of Section 25, Township 18 South, Range 3 West of the 6th Principal Meridian, McPherson County, Kansas described as follows:

Commencing at the Southwest corner of said Southwest Quarter; thence on a NAD 83 Kansas South Zone bearing of North 89°51'35" East on the South line of said Southwest Quarter a distance of 284.63 feet (Record) to the point of beginning; thence North 01°01'22" West parallel with the West line of said Southwest Quarter a distance of 314.39 feet; thence North 89°51'35" East parallel with said South line a distance of 40.00 feet; thence South 01°01'22" East parallel with said West line a distance of 314.39 feet to said South line; thence South 89°51'35" West on said South line a distance of 40.00 feet to the point of beginning.

Containing 3.304 Acres and subject to road right of way easements across the South 30.00 feet and West 33.00 feet thereof, and any other easements or restrictions of record.

SURVEYOR'S CERTIFICATE:

I hereby certify this plat to be a true, correct and complete representation of the property described herein, as surveyed under my supervision, this 28th day of October, 2020.

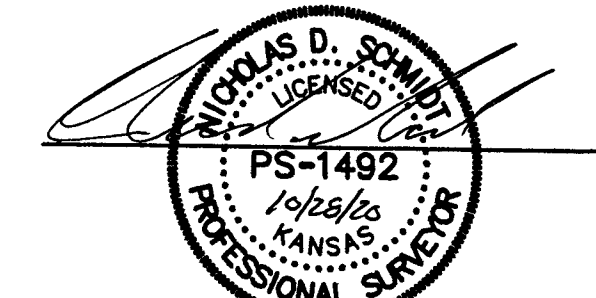

Prepared For:	Description: BRIAN CROWTHER A PORTION OF THE SW 1/4 SECTION 25, T18S, R3W McPHERSON COUNTY, KANSAS		
Prepared By:	Garber Surveying Service, P.A.		
Drawn By:	KLL	Scale: 1"=60'	Date of Field Work: October 2, 2020
Checked By:	NDS	Date: 10/28/2020	Sheet 1 of 1 Sheet(s)
		Job No: G2020-605	

HUTCHINSON (Main Office) 2908 North Plum St. 67502 Ph. 620-665-7032 Fax 620-663-7401
McPHERSON (Branch Office) 206 South Main 67460 Ph. 620-241-4441 Fax 620-241-4458
NEWTON (Branch Office) 511 North Poplar St. 67114 Ph. 316-283-5053 Fax 316-283-5073
MANHATTAN (Branch Office) 3226 Kimball Ave Ste. 82 66503 Ph. 785-320-4810