

525 HOWARD STREET
HUTCHINSON, KS 67501
PHONE: 620-663-9613

0 250 500 1000

1" = 500'

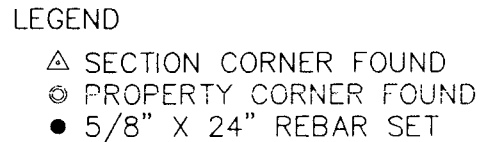

REVIEWED IN ACCORDANCE WITH THE
REQUIREMENTS OF K.S.A. 58-2004,
_____, 2009.

NOTES:
1) NO TITLE WORK PROVIDED TO SURVEYOR PRIOR TO SURVEY
2) SECTION CORNER TIES TO BE SENT TO COUNTY ENGINEER'S
OFFICE AND KANSAS STATE HISTORICAL SOCIETY

I, DUNCAN W. DURR, DO HEREBY CERTIFY THE
HEREON SURVEY TO BE A TRUE AND ACCURATE
REPRESENTATION OF THE CONDITIONS FOUND
ON THE DATE HEREON WRITTEN.

A TRACT IN THE EAST HALF OF THE NORTHEAST QUARTER SECTION 24, TOWNSHIP 19 SOUTH, RANGE 4 WEST OF THE SIXTH PRINCIPAL MERIDIAN, MORE PARTICULARLY DESCRIBED AS FOLLOWS:

BEGINNING 552.20 FEET S0°07'25"E OF THE NORTHEAST CORNER OF SAID EAST HALF OF THE NORTHEAST QUARTER ; THENCE CONTINUING S0°07'25"E, A DISTANCE OF 330.79 FEET; THENCE WEST, A DISTANCE OF 1316.61 FEET TO THE WEST LINE SAID EAST HALF; THENCE N0°05'28"W, A DISTANCE OF 330.79 FEET; THENCE EAST, A DISTANCE OF 1316.42 FEET TO THE POINT OF BEGINNING; TRACT CONTAINS 10.00 ACRES, EXCEPT THE EAST 33 FEET FOR ROAD RIGHT OF WAY AND ANY OTHER EASEMENTS OF RECORD; ALL IN McPHERSON COUNTY, KANSAS.

STATE: KANSAS COUNTY: McPHERSON SEC: 24 TWP: 19 S R: 4 W DATE: 12/31/2009