

DESCRIPTION: That part of the S 1/2 of section 24 - T 19 S - R 3 W of the 6th PM more particularly described as follows: Beginning at the SE Cor. of the SW 1/4 of the SE 1/4 of section 24; thence west along the south line of said section a distance of 318'; thence north a distance of 1307.9' to the 1/16 line; thence east along the 1/16 line a distance of 245.5'; thence south a distance of 158.5'; thence east a distance of 128'; thence south a distance of 1152.27', to the south line of said section; thence west along the south line of said section a distance of 44' to the place of beginning, containing 10.61 Acres more or less.

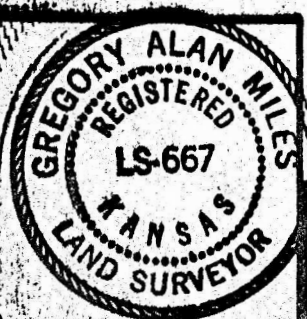

GREAT PLAINS

ENGINEERS & SURVEYORS
MCPHERSON, KANSAS 67460

PROJECT	MC 7818
DATE	June 6, 1978
BY	SH. 1 OF 1