

BASIS OF BEARING = NAD 83 KANSAS SOUTH ZONE 1502

SURVEYOR'S CERTIFICATE:
I hereby certify this plat to be a true, correct and complete representation of the topography of the site shown hereon, as surveyed under my supervision, this 23rd day of December, 2014.

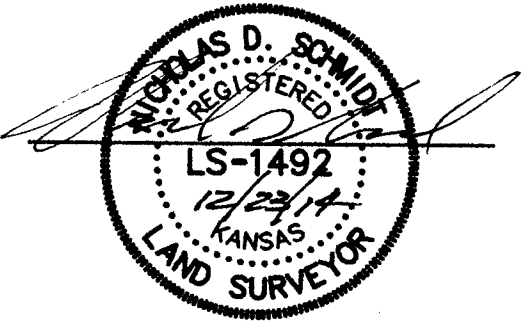

Prepared For: FRANK BLACK PIPE & SUPPLY CO.		Description: A PORTION OF THE NW 1/4 SECTION 24 T19S, R3W MCPHERSON COUNTY, KANSAS	
Prepared By: GSS HUTCHINSON (Main Office) 2988 North Plum St. 67502 Ph. 620-665-7832 Fax 620-663-7401 MCPHERSON (Branch Office) 115 East Main St. 67449 Ph. 620-241-4441 Fax 620-241-4458 NEWTON (Branch Office) 511 North Poplar St. 67114 Ph. 316-283-5851 Fax 316-283-5873		Drawn By: AL Scale: 1"=50' Date of Field Work: Nov. 26, 2014 Job No: Checked By: NDS Date: 12/23/2014 Sheet 1 of 1 Sheet(s) G2014-785	