

Copyright © 2020 Garber Surveying Service, P.A. Saved 5/10/2021 11:07:30 AM by K200K
Plot Date & Time Monday, May 10, 2021 11:11:48 AM Dwg Path E:\LDD\GSSFILES\2021\20210343M\dwg\20210343 KWE Auto N Ground

5TH AVENUE

N 00°08'25" E 2647.52 (M) 2639.34 (PS)

55' R/W Line

SW Cor. SW 1/4
Sec. 24, T18S, R5W
Fd. 5/8" Rebar
Origin: KSHS References by LS 1202 7/15/2011

N 89°56'30" W 2631.88 (M) 2635.38 (PS)
PIONEER ROAD

SE Cor. SW 1/4
Sec. 24, T18S, R5W
Fd. 1/2" Pipe
Origin: KSHS References by McPherson
County Public Works 9/11/2017

NE Cor. NW 1/4
Sec. 24, T18S, R5W
Fd. Railroad Spike
Origin: GSS Project #G2016-8

NE Cor. NW 1/4, SE 1/4
Sec. 24, T18S, R5W
Searched for 12"x12"x4" Sandstone
Reset 5/8" Rebar w/GSS CLS 52 Cap
at fence corner per (PS)

NE Cor. NW 1/4, SE 1/4
Sec. 24, T18S, R5W
Fd. 18"x12"x3" Sandstone
Origin: (PS)

N 89°38'23" E 2622.87 (M) 2633.73 (PS)

S 89°41'58" E
1331.86 (M) 1320.00 (PS)

6.48 Acres

6.48 Acres

Total Paddock Acreage = 51.84 Acres

6.48 Acres

6.48 Acres

6.48 Acres

6.48 Acres

6.48 Acres

6.48 Acres

HOUSE
NO. 2044

Shed

Lagoon

Chicken Barn

-200 0 200 400 600

BASIS OF BEARING = NAD 83 KANSAS SOUTH ZONE

LEGEND

- △ - Sectional Monument Found
- ▲ - Section Monument Set (5/8" x 24" Iron Rebar w/GSS CLS 52 Cap)
- (M) - Measured
- (PS) - Previous Survey by A. Bass 4/17/1885
- x- - Proposed Fence
- - Existing Barb Wire Fence
- ⊕ - Power Pole

DESCRIPTION:

The Southwest Quarter of Section 24, Township 18 South, Range 5 West of the 6th Principal Meridian, McPherson County, Kansas.

Containing 160.26 Acres and subject to road right of way easements across the West and South lines thereof and any other easements and restrictions of record.

SURVEYOR'S NOTE:

Survey was made as per client request and no title work has been provided to the surveyor; therefore, the number and extent of easements and/or rights of way of record affecting said property has not been verified by this Survey.

SURVEYOR'S CERTIFICATE:

I hereby certify this plat to be a true, correct and complete representation of the property described hereon, as surveyed under my supervision, this 10th day of May, 2021.

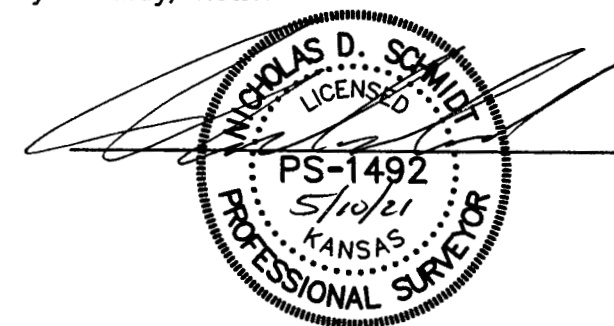

Prepared For: DALLAS NIKKEL		Description: A PORTION OF THE SW 1/4 SECTION 24, T18S, R5W McPHERSON COUNTY, KANSAS	
Prepared By: GSS HUTCHINSON 2908 North Plum St. 67502 Ph. 620-665-7032 (Main Office)		Branch Offices: MANHATTAN Ph. 785-320-4810 MCPHERSON Ph. 620-241-4441 NEWTON Ph. 316-283-5053 SALINA Ph. 785-404-6302 WICHITA Ph. 316-260-9933	
Drawn By: KDZ	Scale: 1"=200'	Date of Field Work: April 15, 2021	Job No: G2021-343
Checked By: NDS	Date: 05/10/2021	Sheet 1 of 1 Sheet(s)	