

- LEGEND**
- △ - Sectional Monument Found
 - - Fd. 5/8" Rebar w/GSS Cap
 - - 5/8" x 24" Iron Rebar Set w/GSS CLS 52 Cap
 - (C) - Calculated
 - (M) - Measured
 - ⊕ - Power Pole
 - ⊙ - Water Well
 - P.O.B. - Point of Beginning
 - P.O.C. - Point of Commencement
 - (PS) - Previous Survey GSS Project #G2023-914

DESCRIPTIONS:

TRACT 2A

A portion of the Northeast Quarter of Section 24, Township 18 South, Range 3 West of the 6th Principal Meridian, McPherson County, Kansas, described as follows by Nicholas D. Schmidt, PS #1492, this 19th day of December, 2023:

Commencing at the Northeast corner of said Northeast Quarter; thence on a NAD 83 Kansas South Zone bearing of South 02°24'18" East on the East line of said Northeast Quarter a distance of 1637.81 feet to the point of beginning; thence continuing South 02°24'18" East on said East line a distance of 1003.34 feet to the Southeast corner of said Northeast Quarter; thence South 89°05'27" West on the South line of said Northeast Quarter a distance of 506.82 feet; thence North 01°35'33" West a distance of 1003.06 feet; thence North 89°05'27" East a distance of 492.60 feet to the point of beginning.

Containing 11.51 Acres and subject to a road right of way easement along the East line thereof, and any other easements or restrictions of record.

TRACT 2B

A portion of the Northeast Quarter of Section 24, Township 18 South, Range 3 West of the 6th Principal Meridian, McPherson County, Kansas, described as follows by Nicholas D. Schmidt, PS #1492, this 19th day of December, 2023:

Beginning at the Northeast corner of said Northeast Quarter; thence on a NAD 83 Kansas South Zone bearing of South 02°24'18" East on the East line of said Northeast Quarter a distance of 1637.81 feet; thence South 89°05'27" West a distance of 1136.35 feet; thence North 01°08'41" West a distance of 1638.49 feet to the North line of said Northeast Quarter; thence North 89°09'19" East on said North line a distance of 1100.33 feet to the point of beginning.

Containing 42.05 Acres and subject to road right of way easements along the North line and East line thereof, and any other easements or restrictions of record.

SURVEYOR'S NOTES:

- Survey was made as per client request and no title work has been provided to the surveyor; therefore, the number and extent of easements and/or rights-of-way of record affecting said property has not been verified by this Survey.
- All measurements are in US Survey Feet.

SURVEYOR'S CERTIFICATE:

I hereby certify this plat to be a true, correct and complete representation of the property described hereon, as surveyed under my supervision, this 19th day of December, 2023.

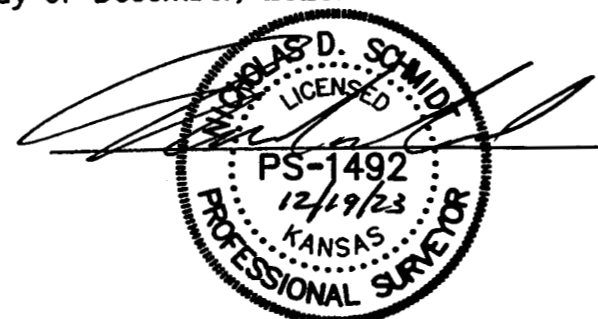

Prepared For:

JANSON INVESTMENTS, LLC

Prepared By:



HUTCHINSON
2908 North Plum St. 67502
Ph. 620-665-7032
(Main Office)

BRANCH OFFICES:
MANHATTAN Ph. 785-320-4810
MCPHERSON Ph. 620-241-4441
NEWTON Ph. 316-283-5053
SALINA Ph. 785-404-6302
WICHITA Ph. 316-260-9933

Drawn By:

KDZ

Scale:

1"=200'

Date of Field Work:

December 18, 2023

Checked By:

NDS

Date:

12/19/2023

Sheet 1 of 1 Sheet(s)

Job No:

G2023-952

Description:

A PORTION OF THE NE 1/4 SECTION 24, T18S, R3W McPHERSON COUNTY, KANSAS