

- LEGEND**
- △ - Sectional Monument Found
 - - 5/8" x 24" Iron Rebar Set w/GSS CLS 52 Cap
 - (C) - Calculated
 - (M) - Measured
 - (R) - Record measurement
 - (PS) - Previous Survey GSS Project #G2021-534
 - (PS1) - Previous Survey by Alpha Land Surveys (10/6/2020)
 - P.O.B. - Point of Beginning
 - P.O.C. - Point of Commencement

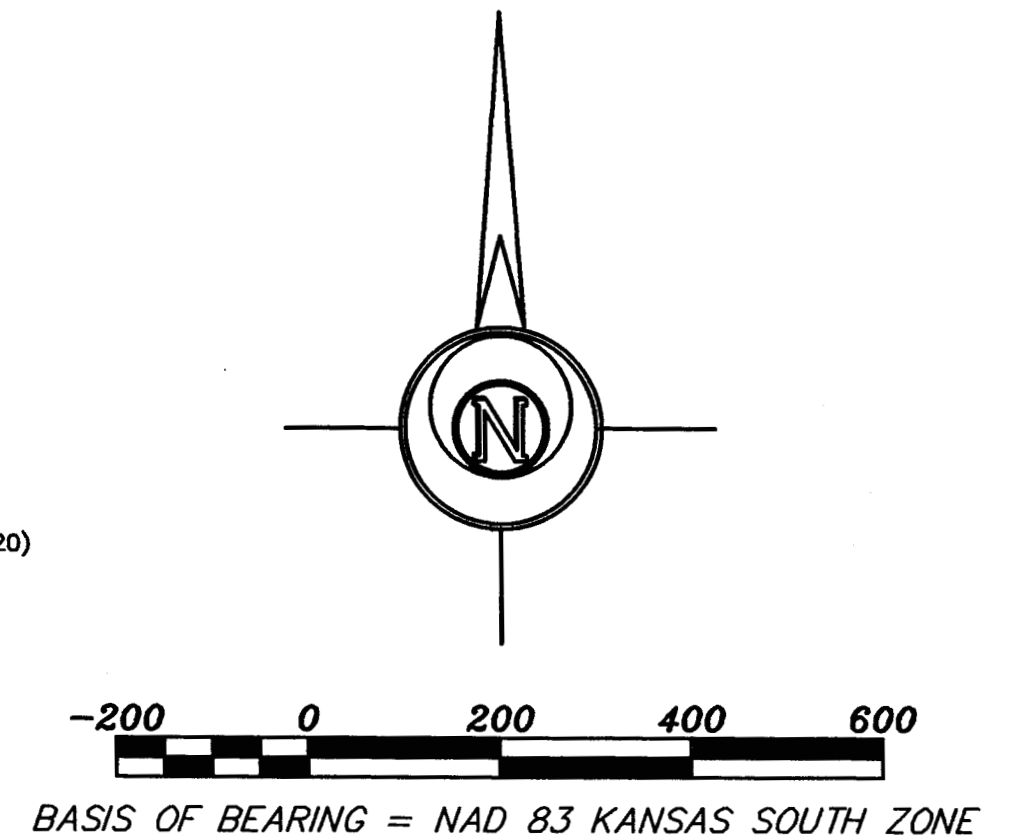

DESCRIPTION:

A portion of the Northeast Quarter of Section 23, Township 21 South, Range 2 West of the 6th Principal Meridian, McPherson, Kansas, described as follows by Nicholas D. Schmidt, PS #1492, this 23rd day of December, 2021:

Commencing at the Southeast corner of said Northeast Quarter; thence on a NAD 83 Kansas South Zone bearing of North 00°06'19" West on the East line of said Northeast Quarter a distance of 107.18 feet (Record) to the point of beginning; thence South 89°46'43" West parallel with the South line of said Northeast Quarter a distance of 454.63 feet (Record); thence North 00°06'19" West parallel with said East line a distance of 1651.58 feet; thence North 09°07'27" East a distance of 366.21 feet to the Southerly Right of Way line of Interstate Highway 135; thence South 50°01'53" East on said Right of Way a distance of 294.68 feet; thence South 20°15'53" East continuing on said Right of Way a distance of 379.00 feet; thence South 89°52'46" East continuing on said Right of way distance of 39.79 feet to the East line of said Northeast Quarter; thence South 00°06'19" East on said East line a distance of 1466.48 feet to the point of beginning.

Containing **18.67 Acres** and subject to a road right of way easement along the East line thereof, and any other easements or restrictions of record.

SURVEYOR'S CERTIFICATE:

I hereby certify this plat to be a true, correct and complete representation of the property described hereon, as surveyed under my supervision, this 23rd day of December, 2021.

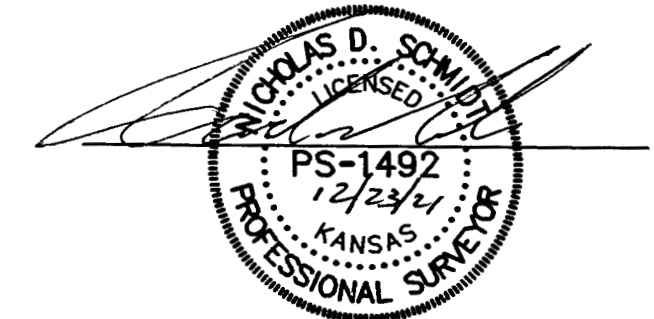

Prepared For: TORTILLA KING		Description: A PORTION OF THE NE 1/4 SECTION 23, T21S, R2W McPHERSON COUNTY, KANSAS	
Prepared By: GSS HUTCHINSON 2908 North Plum St. 67502 Ph. 620-663-7032 (Main Office)		BRANCH OFFICES: MCPHERSON Ph. 620-241-4441 SALINA Ph. 785-404-6302 MANHATTAN Ph. 785-320-4810 NEWTON Ph. 316-283-5053 WICHITA Ph. 316-260-9933	
Drawn By: KDZ	Scale: 1"=200'	Date of Field Work: December 14, 2021	Job No: G2021-1235
Checked By: NDS	Date: 12/23/2021	Sheet 1 of 1 Sheet(s)	