

LEGEND

- △ - Sectional Monument Found
- ▲ - Section Monument Set (5/8" x 24" Iron Rebar w/GSS CLS 52 Cap)
- - Fd. 5/8" Rebar w/GSS CLS 52 Cap
- - 5/8" x 24" Iron Rebar Set w/GSS CLS 52 Cap
- SM - Measured
- (PS) - Previous Survey GSS Project #G1998-163
- P.B. - Point of Beginning
- P.O.C. - Point of Commencement

DESCRIPTION:

PARCEL 1

A portion of Block 10, Elyria and a portion of the Southeast Quarter of the Southwest Quarter of Section 23, Township 20 South, Range 3 West of the 6th Principal Meridian, McPherson County, Kansas described as follows:

Commencing at the Southeast corner of said Southwest Quarter; thence on a NAD 83 Kansas South Zone bearing of North 00°00'18" East on the East line of said Southwest Quarter a distance of 715.06 feet to the North line of vacated Third Street as plotted in said Elyria; thence North 88°40'26" West on said North line a distance of 812.52 feet to the point of beginning; thence South 00°00'18" West parallel with said East line a distance of 200.02 feet to the centerline of the vacated alley in vacated Block 11 of said Elyria; thence North 88°40'26" West on said centerline a distance of 3.76 feet to the extended East line of Lot 27 of said vacated Block 11; thence South 00°00'18" West on said East line a distance of 175.01 feet to the centerline of vacated Second Street of said vacated Block 11; thence North 88°40'26" West on said centerline a distance of 108.75 feet to the East line of Lawrence Street of said Elyria; thence North 00°00'18" East on said East line a distance of 40.01 feet to the North line of Elyria Road (formerly plotted as Second Street); thence North 88°40'26" West on said North line a distance of 30.01 feet to the centerline of vacated Lawrence Street in said Block 10; thence North 00°00'18" East on said centerline a distance of 125.00 feet to the extended North line of Lot 16 in said Block 10; thence North 88°40'26" West a distance of 30.01 feet to the Northeast corner of said Lot 16; thence North 00°00'18" East on the extended East line of said Lot 16 a distance of 10.00 feet to the centerline of the vacated alley; thence North 88°40'26" West a distance of 65.02 feet to the extended West line of Lot 17 in said Block 10; thence South 00°00'18" West on said extended West line and the West line of said Lot 17 a distance of 135.00 feet to the Southwest corner of said Lot 17; thence North 88°40'26" East on said North line a distance of 48.84 feet to the North line of said Lot 10; thence South 88°40'26" East on said North line a distance of 40.01 feet to the centerline of the vacated alley in said Block 10; thence North 00°00'18" East on said centerline a distance of 25.01 feet to the extended North line of Lot 9 in said Block 10; thence North 88°40'26" West on said extended North line and the North line of said Lot 9 a distance of 85.02 feet to the East line of the West 50.00 feet (Record) of said Lots 9, 10 and 11; thence South 00°00'18" West on said East line a distance of 74.95 feet to the South line of said Lot 11; thence North 88°40'26" West on said South line a distance of 50.01 feet to the Southwest corner of said Lot 11; thence North 00°00'18" East on the West line of said Block 10 a distance of 335.02 feet to the North line of vacated Third Street; thence North 88°40'26" West on said North line a distance of 49.81 feet to the centerline of Main Street of said Elyria and the West line of the Southeast Quarter of said Southwest Quarter; thence North 00°00'18" West on said West line a distance of 272.39 feet to the Northwest corner of the South Half of the North Half of the Southeast Quarter of said Southwest Quarter; South 88°43'59" East on the North line of said South Half a distance of 397.52 feet to a point 922.52 feet West of the Northeast corner of said South Half; thence South 00°00'18" West parallel with the East line of said Southwest Quarter a distance of 272.80 feet (Record) to the North line of vacated Third Street; thence South 88°40'26" East on said North line a distance of 110.00 feet to the point of beginning.

Containing 5.705 Acres and subject to any easements or restrictions of record.

SURVEYOR'S CERTIFICATE:

I hereby certify this plat to be a true, correct and complete representation of the property described hereon, as surveyed under my supervision, this 5th day of October, 2020.

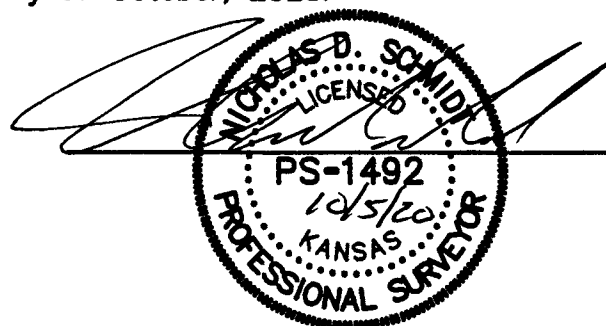

WBH
1-4-2020

Prepared For: LARRY KREHBIEL		Description: A PORTION OF THE SW 1/4 SECTION 23, T20S, R3W McPHERSON COUNTY, KANSAS	
Prepared By: GSS		Garber Surveying Service, P.A.	
HUTCHINSON (Main Office) 2908 North Plum St. 67502 Ph. 620-665-7032 Fax 620-663-7401		McPHERSON (Branch Office) 206 South Main 67460 Ph. 620-241-4441 Fax 620-241-4458	
NEWTON (Branch Office) 511 North Poplar St. 67114 Ph. 316-283-5053 Fax 316-283-5073		MANHATTAN (Branch Office) 3226 Kimball Ave. Ste. #2 66503 Ph. 785-320-4810	
Drawn By: KDZ	Scale: 1"=40'	Date of Field Work: September 21, 2020	Job No: G2020-719
Checked By: NDS	Date: 10/05/2020	Sheet 1 of 2 Sheet(s)	