

▲ - Section Corner Monument Found
 ● - Section Corner Monument Set (5/8" Rebar w/GSS CLS 52 Cap)
 ○ - 5/8" Rebar Set w/GSS CLS 52 Cap
 (C) - Calculated
 (M) - Measured
 P.O.B. - Point of Beginning
 (PS) - Previous Survey GSS Project #G2016-516
 (PS1) - Previous Survey GSS Project #G2025-20
 (GLO) - General Land Office

The Northeast Quarter of the Northeast Quarter of Section 22, Township 22 South, Range 2 West of the 6th Principal Meridian, McPherson County, Kansas.

SURVEYOR'S NOTES:

1. Survey was made as per client request and no title work has been provided to the surveyor; therefore, the number and extent of easements and/or rights-of-way of record affecting said property has not been verified by this Survey.
2. All measurements are in US Survey Feet.

I hereby certify this plat to be a true, correct and complete representation of the property described hereon, as surveyed under my supervision, this 3rd day of April, 2025.

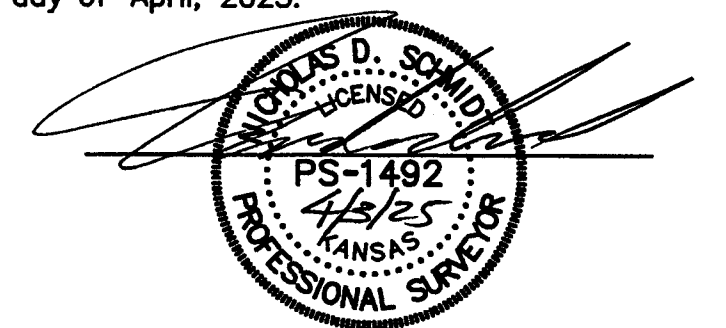

Copyright © 2025 Corber Surveying Service, P.A. Saved 4/3/2025 9:38:56 AM by GQUIGLEY
Plot Date & Time Thursday, April 3, 2025 9:39:54 AM Dwg Path U:\LDD\GSSFILES\2025\20250118_C3d.dwg\20250118_BOUNDARY