

40 0 40 80 120  
BASIS OF BEARING = NAD 83 KANSAS SOUTH ZONE

#### LEGEND

- △ - Sectional Monument Found
- - Survey Monument Found 5/8" Rebar from (PS) unless otherwise noted
- - Sanitary Sewer Cleanout
- - Fence
- - Guy Anchor
- - Gas Meter
- - Sanitary Sewer Manhole
- - Power Pole
- - Water Meter
- - Storm Sewer Manhole
- - Electric Meter
- - Benchmark/Control Point
- - Overhead Electric
- - Underground Electric
- - Cable TV
- - Gas Line
- - Water Line
- - Fiber Optic
- (C) - Calculated
- (M) - Measured
- (PS) - Previous Survey by LS 121 8/20/1980
- - Concrete
- ▨ - Asphalt
- ▨ - Gravel
- ▨ - Ballast
- - Tree
- - Railroad Track

#### DESCRIPTION OF RECORD: (Bk. 246, Pg. 936)

A part of the Southeast Quarter of Section 22, Township 19 South, Range 3 West of the 6th P.M., in the County of McPherson, State of Kansas more particularly described as follows:

Beginning at Southeast corner of the Southwest Quarter of said Southeast Quarter, hence West along the section line, 80 feet; thence North parallel with the East line of said Southwest Quarter of the Southeast Quarter, approximately 236.7 feet, more or less, across the railroad spur, to a point 11 feet North of the center line of said railroad spur, thence in a Northwesterly direction continuing along a line 11 feet North of the center line of the most Northerly spur track upon said property, approximately 757.1 feet, more or less, to the A.T. & S.F. Railroad right of way, thence Northeasterly along said railroad right of way, approximately 757.1 feet, more or less, to the East line of said Southwest Quarter of the Southeast Quarter; thence South along said East line approximately 718.1 feet, more or less, to the place of beginning.

Subject to a perpetual, nonexclusive easement of record created by deed recorded in Book 178 of Deed, at page 591.

#### GENERAL NOTES:

- Survey was made as per client request and no title work has been provided to the surveyor; therefore, the number and extent of easements and/or rights-of-way of record affecting said property has not been verified by this survey.

#### SURVEYOR'S CERTIFICATE:

I hereby certify this plat to be a true, correct and complete representation of the topography of the site shown hereon, as surveyed under my supervision, this 14th day of December, 2018.

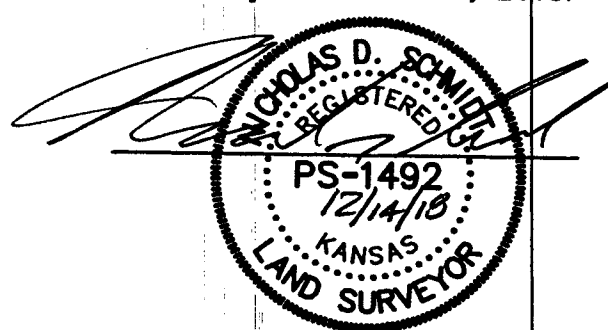

Prepared For: <b>PLAN 4 ARCHITECTURE AND DESIGN</b>		Description: <b>A PORTION OF THE SE 1/4 SECTION 22, T19S, R3W McPHERSON COUNTY, KANSAS</b>	
Prepared By: <b>GSS</b>		Garber Surveying Service, P.A.	
HUTCHINSON (Main Office) 2908 North Plum St. 67502 McPHERSON (Branch Office) 115 East Marlin 67460 NEWTON (Branch Office) 511 North Poplar St. 67114 MANHATTAN (Branch Office) 3226 Kimball Ave. Ste. 202 66503		Ph. 620-665-7032 Fax 620-663-7401 Ph. 620-241-4441 Fax 620-241-4458 Ph. 316-283-5053 Fax 316-283-5073 Ph. 785-339-4810	
Drawn By: KDZ	Scale: 1"=40'	Date of Field Work: December 10, 2018	Job No:
Checked By: NDS	Date: 12/14/2018	Sheet 1 of 1 Sheet(s)	G2018-880