

|     |               |        |
|-----|---------------|--------|
| L1  | S 00°56'23" W | 79.11  |
| L2  | S 18°56'55" W | 101.21 |
| L3  | S 09°12'05" W | 118.68 |
| L4  | S 21°43'52" W | 105.80 |
| L5  | S 23°45'09" W | 189.53 |
| L6  | S 14°23'22" W | 102.97 |
| L7  | S 10°20'45" W | 390.41 |
| L8  | S 04°47'52" W | 154.11 |
| L9  | S 00°09'05" W | 126.76 |
| L10 | S 00°09'05" W | 185.79 |
| L11 | S 04°09'37" W | 120.80 |
| L12 | S 83°46'31" W | 320.08 |
| L13 | S 80°13'48" W | 251.94 |
| L14 | S 62°31'46" W | 119.93 |
| L15 | S 35°23'40" W | 102.32 |
| L16 | S 10°25'21" W | 168.48 |
| L17 | S 10°29'43" W | 131.42 |
| L18 | S 16°25'11" W | 130.30 |
| L19 | S 15°37'02" W | 170.21 |
| L20 | S 18°10'56" W | 111.18 |
| L21 | S 23°12'50" W | 269.96 |
| L22 | S 09°53'20" W | 85.28  |
| L23 | S 09°53'20" W | 30.95  |
| L24 | S 18°08'23" W | 58.45  |
| L25 | S 51°30'26" W | 80.01  |
| L26 | S 48°27'56" W | 78.16  |
| L27 | S 32°34'57" W | 244.42 |
| L28 | S 37°10'32" W | 115.17 |
| L29 | S 27°51'58" W | 116.16 |
| L30 | S 32°03'56" W | 93.71  |
| L31 | S 24°20'24" W | 95.65  |
| L32 | S 05°25'24" E | 95.71  |
| L33 | S 26°08'22" E | 168.97 |
| L34 | S 34°57'23" E | 161.39 |
| L35 | S 26°47'57" E | 115.16 |
| L36 | S 40°31'46" E | 119.88 |
| L37 | S 33°42'35" E | 168.57 |
| L38 | S 45°25'08" E | 101.81 |
| L39 | S 50°03'38" E | 353.96 |
| L40 | S 33°14'08" E | 191.18 |
| L41 | S 27°18'51" E | 97.95  |
| L42 | S 15°27'08" E | 132.31 |
| L43 | S 08°16'53" W | 131.60 |
| L44 | S 21°58'25" W | 394.81 |

#### LEGEND

- △ - Sectional Monument Found
- ▲ - Section Monument Set (5/8" x 24" Iron Rebar w/6.S.S. Cap)
- (C) - Calculated
- (M) - Measured
- (PS) - Previous Survey November 22, 1901 D.A. Bradley
- (PS) - Previous Survey October 3, 2007 W.B. Heller
- P.O.B. - Point of Beginning
- P.O.C. - Point of Commencement
- P.O.T. - Point of Termination

-300 0 300 600 900

BASIS OF BEARING = NAD 83 KANSAS SOUTH ZONE

#### DESCRIPTION:

##### PROPOSED INGRESS/EGRESS EASEMENT #1

A proposed Ingress/Egress Easement over and across a strip of land 12.00 feet in width, located on a portion of the North Half of the Northeast Quarter of Section 22, Township 17 South, Range 02 West of the 6th Principal Meridian, McPherson County, Kansas, the centerline of which is more particularly described as follows:

Commencing at the Northeast corner of said Northeast Quarter; thence on a NAD 83 Kansas South Zone bearing of South 89°00'41" West on the North line of said Northeast Quarter a distance of 427.49 feet to the point of beginning; thence South 00°56'23" West 79.11 feet; thence South 18°56'55" West 101.21 feet; thence South 09°12'05" West 118.68 feet; thence South 21°43'52" West 105.80 feet; thence South 23°45'09" West 189.53 feet; thence South 14°23'22" West 102.97 feet; thence South 10°20'45" West 390.41 feet; thence South 04°47'52" West 154.11 feet; thence South 00°09'05" West 126.76 feet to the South line of the North Half of said Northeast Quarter and the point of termination, said point being 721.71 feet West of the Southeast corner of said North Half, subject to any easements or restrictions of record.

##### PROPOSED INGRESS/EGRESS EASEMENT #2

A proposed Ingress/Egress Easement over and across a strip of land 12.00 feet in width, located on a portion of the South Half of the Northeast Quarter of Section 22, Township 17 South, Range 02 West of the 6th Principal Meridian, McPherson County, Kansas, the centerline of which is more particularly described as follows:

Commencing at the Northeast corner of the South Half of said Northeast Quarter; thence on a NAD 83 Kansas South Zone bearing of South 89°03'58" West on the North line of said South Half 721.71 feet to the point of beginning; thence South 00°09'05" West 185.79 feet; thence South 04°09'37" West 120.80 feet; thence South 83°46'31" West 320.08 feet; thence South 80°13'48" West 251.94 feet; thence North 62°31'46" East 119.93 feet; thence North 35°23'40" East 102.32 feet; thence South 10°25'21" West 168.48 feet; thence South 10°29'43" West 131.42 feet; thence South 16°25'11" West 130.30 feet; thence South 15°37'02" West 170.21 feet; thence South 18°10'56" West 111.18 feet; thence South 23°12'50" West 269.96 feet; thence South 09°53'20" West 85.28 feet to the South line of said South Half and the point of termination, said point being 1040.42 feet West of the Southeast corner of said South Half, subject to any easements or restrictions of record.

##### PROPOSED INGRESS/EGRESS EASEMENT #3

A proposed Ingress/Egress Easement over and across a strip of land 12.00 feet in width, located on a portion of the Southeast Quarter of Section 22, Township 17 South, Range 02 West of the 6th Principal Meridian, McPherson County, Kansas, the centerline of which is more particularly described as follows:

Commencing at the Northeast corner of said Southeast Quarter; thence on a NAD 83 Kansas South Zone bearing of South 89°05'29" West on the North line of said Southeast Quarter 1040.42 feet to the point of beginning; thence L23 South 09°53'20" West 30.95 feet; thence South 18°08'23" West 58.45 feet; thence South 51°30'26" West 80.01 feet; thence South 48°27'56" West 78.16 feet; thence South 32°34'57" West 244.42 feet; thence South 37°10'32" West 115.17 feet; thence South 27°51'58" West 116.16 feet; thence South 32°03'56" West 93.71 feet; thence South 24°20'24" West 95.65 feet; thence South 05°25'24" East 95.71 feet; thence South 26°08'22" East 168.97 feet; thence South 34°57'23" East 161.39 feet; thence South 26°47'57" East 115.16 feet; thence South 40°31'46" East 119.88 feet; thence South 33°42'35" East 168.57 feet; thence South 45°25'08" East 101.81 feet; thence South 50°03'38" East 353.96 feet; thence South 33°14'08" East 191.18 feet; thence South 27°18'51" East 97.95 feet; thence South 15°27'08" East 132.31 feet; thence South 08°16'53" West 131.60 feet; thence South 21°58'25" West 394.81 feet to the South line of said Southeast Quarter and the point of termination, said point being 801.52 feet West of the Southeast corner of said Southeast Quarter, subject to any easements or restrictions of record.

##### PROPOSED INGRESS/EGRESS EASEMENT #4

A proposed Ingress/Egress Easement over and across a strip of land 12.00 feet in width, located on a portion of the South Half of the Northeast Quarter of Section 22, Township 17 South, Range 02 West of the 6th Principal Meridian, McPherson County, Kansas, the centerline of which is more particularly described as follows:

Commencing at the Northeast corner of the South Half of said Northeast Quarter; thence on a NAD 83 Kansas South Zone bearing of South 00°43'08" East on the East line of said South Half a Half 102.04 feet to the point of beginning; thence South 83°46'31" West 320.08 feet; thence South 80°13'48" West 251.94 feet; thence North 62°31'46" East 119.93 feet; thence North 35°23'40" East 102.32 feet; thence South 10°25'21" West 168.48 feet; thence South 10°29'43" West 131.42 feet; thence South 16°25'11" West 130.30 feet; thence South 15°37'02" West 170.21 feet; thence South 18°10'56" West 111.18 feet; thence South 23°12'50" West 269.96 feet; thence South 09°53'20" West 85.28 feet to the South line of said South Half and the point of termination, said point being 1040.42 feet West of the Southeast corner of said South Half, subject to any easements or restrictions of record.

#### SURVEYOR'S NOTES:

- No evidence of stone monument from (PS). Reset using physical evidence by splitting the old North and South R/W fence lines and in line with fence line South. Measured distances to the Center, NW and NE section corners agree with (PS) distances.
- No evidence of stone monument from (PS). Reset using physical evidence at the corner of the single fence line North and West. Measured distances to the Center, SE and NE section corners agree with (PS) distances.
- No evidence of stone monument from (PS). Reset using physical evidence by splitting the remnants of the old West Right of Way fence and the newer East R/W fence, intersected with the split North and South R/W fences to the West. Measured distances to the N 1/4 and E 1/4 section corners agree with (PS) distances.
- No evidence of stone monument from (PS). Reset using physical evidence and the intersection of the East/West and fence line North.

#### SURVEYOR'S CERTIFICATE:

I hereby certify this plat to be a true, correct and complete representation of the property described hereon, as surveyed under my supervision, this 14th day of December, 2015.

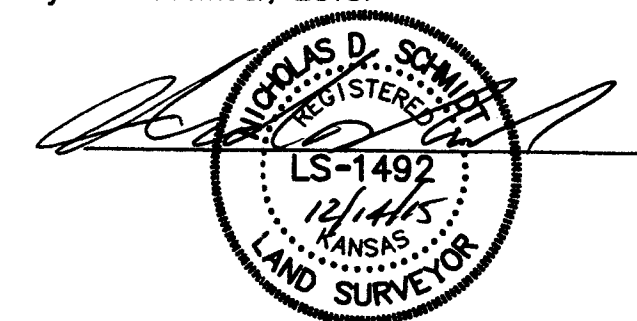

|                                       |  |
|---------------------------------------|--|
| Prepared For:                         | Description:   |
| KARSTETTER & BINA LLC                 | A PORTION OF THE E 1/2 SECTION 22, T17S, R2W, McPHERSON COUNTY, KANSAS   |
| Prepared By:                          | Garber Surveying Service, P.A.   |
| GSS                                   | HUTCHINSON (Main Office) 2908 North Plum St. 67502 Ph. 620-665-7032 Fax 620-663-7401<br>McPHERSON (Branch Office) 115 East Marlin 67460 Ph. 620-241-4441 Fax 620-241-4458<br>NEWTON (Branch Office) 511 North Poplar St. 67114 Ph. 316-283-5053 Fax 316-283-5073 |
| Drawn By: KLL                         | Scale: 1"=300'   |
| Checked By: DEG                       | Date: 12/14/2015   |
| Date of Field Work: November 24, 2015 | Job No: G2015-836  |
| Sheet 1 of 1 Sheet(s)                 |  |