

**SURVEYOR'S CERTIFICATE:**

I hereby certify this plat to be a true, correct and complete representation of the property described hereon, as surveyed under my supervision, this 3rd day of June, 2016.

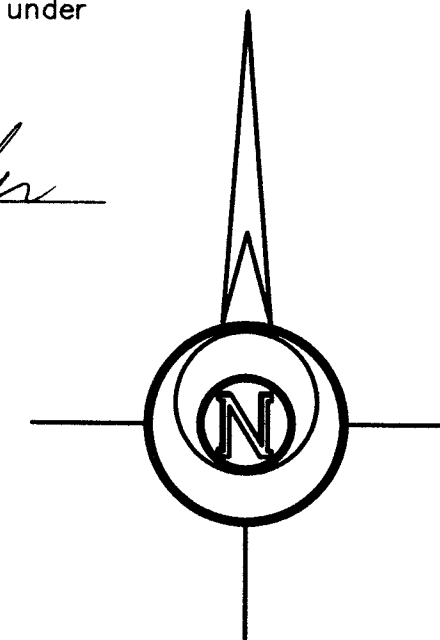
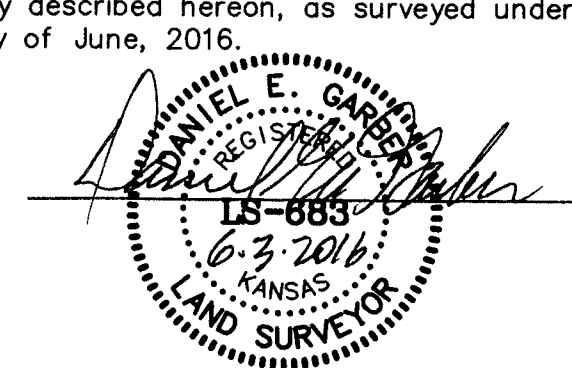

BASIS OF BEARING = NAD 83 KANSAS SOUTH ZONE

Prepared For: <b>ANDREW DYCK</b>		Description: <b>A PORTION OF THE N 1/2 SECTION 21, T21S, R01W MCPHERSON COUNTY, KANSAS</b>	
Prepared By: <b>GSS</b>		<b>Garber Surveying Service, P.A.</b>	
HUTCHINSON (Main Office) 2908 North Plum St. 67502 Ph. 620-665-7032 Fax 620-663-7401		McPHERSON (Branch Office) 115 East Marlin 67460 Ph. 620-241-4441 Fax 620-241-4458	
NEWTON (Branch Office) 511 North Poplar St. 67114 Ph. 316-283-5053 Fax 316-283-5073			
Drawn By: RLE	Scale: 1"=200'	Date of Field Work: May 18, 2016	Job No: G2016-199
Checked By: DEG	Date: 6/3/2016	Sheet 1 of 1 Sheet(s)	