

-100 0 100 200 300

BASIS OF BEARING = NAD 83 KANSAS SOUTH ZONE

LEGEND

- △ - Sectional Monument Found
- ▲ - Section Monument Set (5/8" x 24" Iron Rebar w/GSS CLS 52 Cap)
- - 5/8" x 24" Iron Rebar Set w/GSS CLS 52 Cap
- (C) - Calculated
- (M) - Measured
- P.O.B. - Point of Beginning
- BLM - Bureau of Land Management

DESCRIPTION:

A portion of the South Half of the Northwest Quarter of Section 21, Township 17 South, Range 5 West of the 6th Principal Meridian, McPherson County, Kansas, described as follows by Nicholas D. Schmidt, PS #1492, this 27th day of July, 2022:

Beginning at the Northwest corner of said South Half; thence on a NAD 83 Kansas South Zone bearing of North 89°42'26" East on the North line of said South Half a distance of 762.31 feet; thence South 03°47'23" West a distance of 385.33 feet; thence South 86°11'52" West a distance of 237.19 feet; thence North 68°18'27" West a distance of 207.94 feet; thence South 85°35'54" West a distance of 301.29 feet to the West line of said Northwest Quarter; thence North 01°05'41" West on said West line a distance of 342.65 feet to the point of beginning.

Containing 6.15 Acres and subject to road a right of way easement along the West line thereof, and any other easements or restrictions of record.

SURVEYOR'S CERTIFICATE:

I hereby certify this plat to be a true, correct and complete representation of the property described hereon, as surveyed under my supervision, this 27th day of July, 2022.

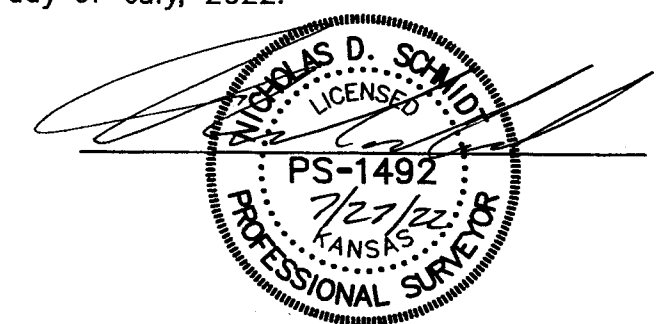

SURVEYOR'S NOTE:

- Survey was made as per client request and no title work has been provided to the surveyor; therefore, the number and extent of easements and/or rights-of-way of record affecting said property has not been verified by this Survey.

SE Cor. SW 1/4
Sec. 21, T17S, R5W
Fd. 3" BLM Iron "T" Bar
Origin: KSHS References by LS 1202 4/25/2007

Prepared For:		Description:				
ANDREA WILLEMS		A PORTION OF THE S 1/2, NW 1/4 SECTION 21, T17S, R5W McPHERSON COUNTY, KANSAS				
Prepared By:		Garber Surveying Service, P.A.				
		HUTCHINSON 2908 North Plum St. 67502 Ph. 620-665-7032 (Main Office)				
		BRANCH OFFICES: MANHATTAN Ph. 785-320-4810 MCPHERSON Ph. 620-241-4441 NEWTON Ph. 316-283-5053 SALINA Ph. 785-404-6302 WICHITA Ph. 316-260-9933				
Drawn By:	KDZ	Scale:	1"=100'	Date of Field Work:	July 19, 2022	Job No: G2022-579
Checked By:	NDS	Date:	7/27/2022	Sheet 1 of 1 Sheet(s)		