

DESCRIPTION:

TRACT 1

A portion of the Northwest Quarter of Section 20, Township 20 South, Range 2 West of the 6th Principal Meridian, McPherson County, Kansas, described as follows by Nicholas D. Schmidt, PS #1492, this 7th day of November, 2022:

Beginning at the Northwest corner of said Northwest Quarter; thence on a NAD 83 Kansas South Zone bearing of North 88°24'42" East 00°50'24" East on the East line of said Northwest Quarter a distance of 2642.63 feet to the Northeast corner of said Northwest Quarter; thence South 25°09'25" West on the South line of said Northwest Quarter a distance of 2596.33 feet to the Southeast corner of said Northwest Quarter; described in Book 668, Page 6724 at the McPherson County Register of Deeds Office; thence North 42°09'33" East on the East line of said parcel a distance of 103.23 feet (102.63 Record); thence North 89°09'25" East departing said East line a distance of 408.44 feet; thence North 00°50'43" West parallel with the West line of said Northwest Quarter a distance of 856.60 feet to the centerline of Running Turkey Creek; thence along said centerline for the following 10 courses:

North 73°38'10" West a distance of 153.72 feet;
 South 78°10'32" West a distance of 110.63 feet;
 North 79°05'37" West a distance of 98.00 feet;
 North 60°35'41" West a distance of 287.95 feet;
 North 21°13'27" West a distance of 261.04 feet;
 North 49°54'26" West a distance of 78.19 feet;
 South 85°18'55" West a distance of 160.02 feet;
 South 25°01'35" West a distance of 52.28 feet;
 South 03°39'43" East a distance of 54.32 feet;
 South 19°10'18" West a distance of 258.70 feet to said West line; thence North 00°50'43" West on said West line a distance of 1499.62 feet to the point of beginning.

Containing **130.76 Acres** and subject to road right of way easements along the West and North lines thereof, and any other easements or restrictions of record.

TRACT 2

A portion of the Northwest Quarter of Section 20, Township 20 South, Range 2 West of the 6th Principal Meridian, McPherson County, Kansas, described as follows by Nicholas D. Schmidt, PS #1492, this 7th day of November, 2022:

Commencing at the Southwest corner of said Northwest Quarter; thence on a NAD 83 Kansas South Zone bearing of North 00°50'43" West on the West line of said Northwest Quarter a distance of 770.00 feet (Record) to the Northwest corner of a parcel described in Book 668, Page 6724 at the McPherson County Register of Deeds Office, being the point of beginning; thence continuing North 00°50'43" West on said West line a distance of 292.34 feet to the centerline of Running Turkey Creek; thence along said centerline for the following 10 courses: North 19°10'18" East a distance of 258.70 feet;

North 19°10'18" East a distance of 258.70 feet;
 North 03°39'43" West a distance of 54.32 feet;
 North 25°01'35" East a distance of 52.28 feet;
 North 85°18'55" East a distance of 160.02 feet;
 South 49°54'26" East a distance of 78.19 feet;
 South 21°13'27" East a distance of 261.04 feet;
 South 60°35'41" East a distance of 287.95 feet;
 South 79°05'37" East a distance of 98.00 feet;
 North 78°10'32" East a distance of 110.63 feet;
 South 73°38'10" East a distance of 153.72 feet; thence South 00°50'43" East parallel with said West line a distance of 856.60 feet;
 thence South 89°09'25" West a distance of 408.44 feet to the East line of said parcel; thence North 00°50'43" West on said East line a
 distance of 695.00 feet (Record) to the Northeast corner of said parcel; thence South 89°06'38" West on the North line of said parcel a
 distance of 610.00 feet (Record) to the point of beginning.

Containing **14.96 Acres** and subject to a road right of way easement along the West line thereof, and any other easements or restrictions of record.

SURVEYOR'S CERTIFICATE:

I hereby certify this plat to be a true, correct and complete representation of the property described hereon, as surveyed under my supervision, this 11th day of November, 2022.

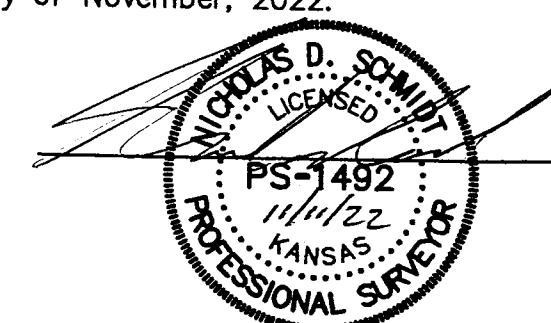

LINE TABLE		
LINE NUMBER	BEARING	DISTANCE
L1	N 00°50'43" W	292.34 (M)
L2	N 19°10'18" E	258.70 (M)
L3	N 03°39'43" W	54.32 (M)
L4	N 25°01'35" E	52.28 (M)
L5	N 85°18'55" E	160.02 (M)
L6	S 49°54'26" E	78.19 (M)
L7	S 21°13'27" E	261.04 (M)
L8	S 60°35'41" E	287.95 (M)
L9	S 79°05'37" E	98.00 (M)
L10	N 78°10'32" E	110.63 (M)
L11	S 73°38'10" E	153.72 (M)

SURVEYOR'S NOTE:

1. Survey was made as per client request and no title work has been provided to the surveyor; therefore, the number and extent of easements and/or rights-of-way of record affecting said property has not been verified by this Survey.