

- LEGEND**
- △ - Sectional Monument Found
 - - Fd. 5/8" Rebar w/GSS Cap unless otherwise noted
 - ⊙ - R/W Marker
 - ⊕ - Fire Hydrant
 - ⊖ - Water Valve
 - ⊗ - Fence
 - ⊙ - Light Pole
 - ⊕ - Power Pole
 - (C) - Calculated
 - (M) - Measured
 - (P) - Previous Survey GSS Project #2015-747
 - (PS) - Previous Survey GSS Project #2015-102
 - O-E- Overhead Electric Line
 - U-E- Underground Electric Line
 - U-T- Underground Telephone Line
 - W- Water Line

DESCRIPTION OF RECORD:

A portion of the Northwest Quarter of Section 20, Township 19 South, Range 3 West of the 6th Principal Meridian, McPherson County, Kansas described as follows:

Commencing at the Southwest corner of said Northwest Quarter; thence on a NAD 83 Kansas South Zone bearing of North 00°19'38" West on the West line of said Northwest Quarter a distance of a distance of 328.18 feet; thence South 89°48'55" East parallel with the South line of said Northwest Quarter a distance of 1146.97 feet to the West Right of Way line of US Highway 81 Bypass; thence South 35°59'24" West along said Right of Way a distance of 128.29 feet; thence continuing along said Right of Way following the arc of a curve to the left having a radius of 5790.42 feet a distance of 272.38 feet (chord bears South 34°48'31" West a distance of 272.36 feet) to the South line of said Northwest Quarter; thence North 89°48'55" West on said South line a distance of 914.24 feet to the point of beginning.

Containing 7.749 Acres and subject to a road right of way easement across the West 33.00 feet thereof, and any other easements or restrictions of record.

AND

A portion of the Southwest Quarter of Section 20, Township 19 South, Range 3 West of the 6th Principal Meridian, McPherson County, Kansas described as follows:

Beginning at the Northwest corner of said Southwest Quarter; thence South 89°32'24" East (basis of bearings is assumed) along the North line of said Southwest Quarter 488.31 feet; thence South 00°07'27" East 330.11 feet (330.00 feet Record); thence North 89°32'24" West parallel with the North line of said Southwest Quarter 489.02 feet to the West line of said Southwest Quarter; thence North 00°00'00" East along the West line of said Southwest Quarter 330.11 feet (330.00 feet Record) to the point of beginning, containing 3.703 Acres, subject to a road right-of-way easement across the West 33.00 feet thereof and any other easements of record.

AND

A portion of the Southwest Quarter of Section 20, Township 19 South, Range 3 West of the 6th Principal Meridian, McPherson County, Kansas described as follows:

Commencing at the Northwest corner of said Southwest Quarter; thence South 89°32'24" East (basis of bearings is assumed) along the North line of said Southwest Quarter 488.31 feet for the point of beginning; thence continuing South 89°32'24" East along the North line of said Southwest Quarter 197.94 feet; thence South 00°07'27" East 330.11 feet (330.00 feet Record); thence North 89°32'24" West parallel with the North line of said Southwest Quarter 197.94 feet; thence North 00°07'27" West 330.11 feet (330.00 feet Record) to the point of beginning, containing 1.500 Acres, subject to any easements of record.

SURVEYOR'S CERTIFICATE:

I hereby certify this plat to be a true, correct and complete representation of the topography of the site shown hereon, as surveyed under my supervision, this 9th day of May, 2019.

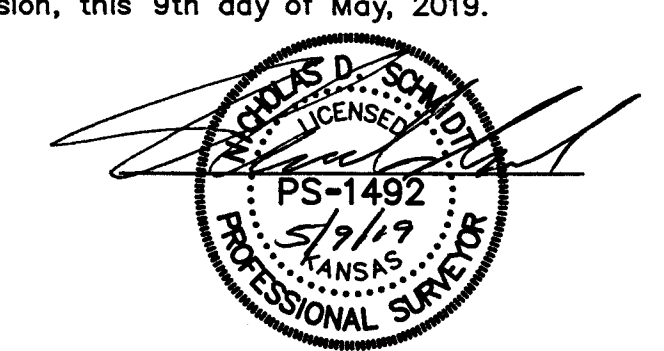
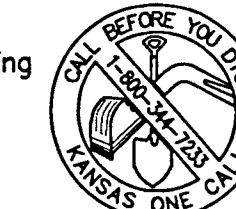

DIGSAFE:

Utility locations shown hereon are based on information received from Kansas One-Call (1-800-DIG-SAFE) identified by following Ticket #19108572 on March 29, 2019.

Before any digging, contractor should verify utility locations by calling 1-800-DIG-SAFE.

CONTROL POINTS:

CP-50
5/8" Rebar w/Yellow GSS CLS 52 cap, 20.0' NE of Piping Technology sign, Northeast property corner.
N: 1939000.00 E: 1546999.78

CP-51
5/8" Rebar w/Red GSS CLS 52 cap, 25.0' Northwest of North end CMP, North of North Entrance.
N: 1938643.76 E: 1546745.16

BENCHMARK (NAVD88 Datum):

BM-1
Square cut in Southeast corner of concrete pad in front of metal building.
Elevation=1500.83 NAVD88

Prepared For: PIPING TECHNOLOGY COMPANY		Description: A PORTION OF THE NW 1/4 SECTION 20, T19S, R3W McPHERSON COUNTY, KANSAS	
Prepared By: GSS		Garber Surveying Service, P.A.	
HUTCHINSON (Main Office) 2908 North Plum St. 67502 Ph. 620-665-7032 Fax: 620-663-7401		McPHERSON (Branch Office) 115 East Main St. 67460 Ph. 620-241-4441 Fax: 620-241-4458	
NEWTON (Branch Office) 511 North Poplar St. 67114 Ph. 316-283-5053 Fax: 316-283-5073		MANHATTAN (Branch Office) 3226 Kimball Ave. Ste. #2 66503 Ph. 785-320-4810	
Drawn By: KZDK	Scale: 1"=50'	Date of Field Work: April 3, 2019	Job No: G2019-187
Checked By: NDS	Date: 05/09/2019	Sheet 1 of 1 Sheet(s)	

Revised May 9, 2019