

DESCRIPTIONS:

PARCEL 1

A portion of the Northeast Quarter of Section 2, Township 20 South, Range 3 West of the 6th Principal Meridian, McPherson County, Kansas described as follows:

Beginning at the Northeast corner of the Northeast Quarter of Section 2, Township 20 South, Range 3 West of the 6th Principal Meridian; thence on a Kansas State Plane Zone 1502 Bearing of South 03°31'57" West along the East line of said Northeast Quarter 1780.83; thence North 89°33'36" West parallel with the South line of said Northeast Quarter 2494.38 feet to the East Right of Way line of Interstate 135; thence North 01°17'51" East along said Right of Way line 1728.88 feet to a point on the North line of said Northeast Quarter, said point being 79.60 feet (Record) East of the Northwest corner of said Northeast Quarter; thence North 89°17'05" East along the North line of said Northeast Quarter 2565.09 feet to the point of beginning, containing **101.784 Acres**, subject to road right of way easements across the North and East 33.00 feet thereof and any other easements or restrictions of record.

PARCEL 2

Portions of the Northeast Quarter and Southeast Quarter of Section 2, Township 20 South, Range 3 West of the 6th Principal Meridian, McPherson County, Kansas described as follows:

Beginning at the Northeast corner of the Southeast Quarter of Section 2, Township 20 South, Range 3 West of the 6th Principal Meridian; thence on a Kansas State Plane Zone 1502 Bearing of South 00°44'22" East along the East line of said Southeast Quarter 859.60 feet; thence North 89°36'36" West parallel with the North line of said Southeast Quarter 2438.00 feet to the East Right of Way line of Interstate 135; thence North 19°59'24" East along said Right of Way line 753.28 feet (Record); thence North 88°47'24" East continuing along said Right of Way 365.10 feet (Record); thence North 00°21'24" East continuing along said Right of Way 130.00 feet (Record) to the North line of said Southeast Quarter; thence continuing North 00°21'24" East along said Right of Way 130.00 feet (Record); thence North 89°38'36" West continuing along said Right of Way 345.00 feet (Record); thence North 19°36'36" West continuing along said Right of Way 847.80 feet (Record); thence North 01°17'51" East continuing along said Right of Way 141.33 feet; thence departing said Right of Way South 89°36'36" East parallel with the South line of the Northeast Quarter of said Section 2 a distance of 2494.38 feet to the East line of said Northeast Quarter; thence South 03°31'57" West along the East line along the East line of said Northeast Quarter 1059.77 feet to the point of beginning, containing **99.330 Acres**, subject to a road right of way easement across the East 33.00 feet thereof and any other easements or restrictions of record.

PARCEL 3

A portion of the Southeast Quarter of Section 2, Township 20 South, Range 3 West of the 6th Principal Meridian, McPherson County, Kansas described as follows:

Beginning at the Southeast corner of the Southeast Quarter of Section 2, Township 20 South, Range 3 West of the 6th Principal Meridian; thence on a Kansas State Plane Zone 1502 Bearing of North 89°32'26" West along the South line of said Southeast Quarter 2540.79 feet to a point on the East Right of Way line of Interstate 135, said point being 127.00 feet (Record) East of the Southwest corner of said Southeast Quarter; thence along said Right of Way following the arc of a curve to the right having a radius of 17038.74 feet a distance of 407.20 feet (Chord bears North 00°37'54" East 407.19 feet); thence North 01°14'24" East continuing along said Right of Way 1208.70 feet (Record); thence North 19°59'24" East continuing along said Right of Way 141.72 feet; thence departing said Right of Way South 89°36'36" East parallel with the North line of said Southeast Quarter 2438.00 feet to the East line of said Southeast Quarter; thence South 00°44'22" East along the East line of said Southeast Quarter 1752.68 feet to the point of beginning, containing **100.978 Acres**, subject to road right of way easements across the North and East 33.00 feet thereof and any other easements or restrictions of record.

SURVEYOR'S NOTE:

1) Found Monument is 70.42 East of 5/8" Rebar Found at CL POT Station 180+05.30 for I-135. Plan Distance = 780.49 as Per KDOT Project #35W-59 I-35W-1(60)100 Part 1

2) Searched for iron pin referenced in (PS) but appears to have been destroyed by construction. Reset Mag Nail in asphalt driving lane at intersections of 1/4 section lines.

SURVEYOR'S CERTIFICATE:

I hereby certify this plat to be a true, correct and complete representation of the property described hereon, as surveyed under my supervision, this 9th day of September, 2013.

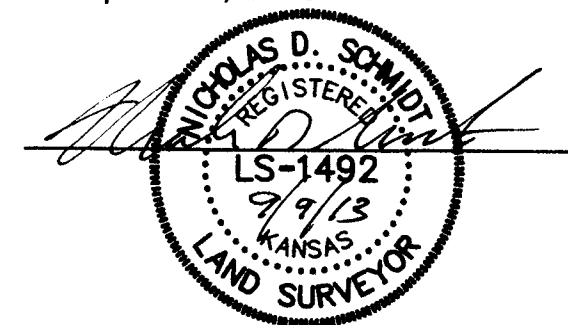

Prepared For: KENT VORAN		Description: PORTIONS OF THE E 1/2 SECTION 2, T20S, R3W MCPHERSON COUNTY, KANSAS	
Prepared By: CSS		Garber Surveying Service, P.A. HUTCHINSON (Main Office) 2908 North Plum St. 67502 Ph. 620-665-7032 Fax 620-463-7401 MCPHERSON (Branch Office) 115 East Marlin 67460 Ph. 620-241-4441 Fax 620-241-4458 NEWTON (Branch Office) 511 North Poplar St. 67114 Ph. 316-283-5053 Fax 316-283-5073	
Drawn By: CSS	Scale: 1"=300'	Date of Field Work: August 27, 2013	Job No:
Checked By: NDS	Date: 9/9/2013	Sheet 1 of 1 Sheet(s)	G2013-524