

McPherson Engineering
& Land Surveying Services
PO Box 662
McPherson, KS 67460
620-241-0950

Client Robert Sellberg
1475 13th Avenue
McPherson, KS

NE Cor. Sec. 19, T19S, R3W

Found $\frac{3}{8}$ " Rebar

Origin Unknown

1. 42.6' SE to dbl. spike in power pole
2. 43.2' NE to dbl. spike in power pole
3. 43.5' NW to dbl. spike in power pole
4. At intersection 13 Ave. and Northview

525.00' N90°00'00"E C

492.00'

1099.97' M

Point of Beginning



206.50' C

296.00' S0°00'00"W C

13th AVENUE (County Road 1065 66' R/W)

East Line Section 19 T19S R3W

89.50' R

1216.97' C

S0°00'00"W Assumed Bearing

South Line N1/2 NE $\frac{1}{4}$ Section 19 T19S R3W

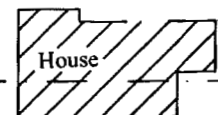

Gravel Driveway

110.0'

295.79' S0°00'00"W M

33' R/W

17'

33'

Fd. $\frac{3}{8}$ " Pins 4' on line, W & S of corner due to Tree.

S89°37'52"E 2648.99' R

50.00' M S 89°37' 52"E 78.20' P

N 89°37' 52"W 128.01' C

N00°00'00"E 69.00' P & M

N 89°37' 52"W 397.00' P & M

M = Measured

C = Calculated

P = Plat

D = Deed

● Set $\frac{1}{2}$ " x 24" Bar and ID

○ Found $\frac{3}{8}$ " Bar/ID in Conc.

Unplatted

Deed 198 pg. 312

Fred D. & L. Karen Spoon

Scale 1"=60'

Legal Description: A part of the Northeast Quarter of Section 19, Township 19 South, Range 3 West of the 6th P.M. described as follows: Commencing at the Northeast corner of said NE $\frac{1}{4}$, thence S0°00'00"W 1099.97 feet to the point of beginning; thence S0°00'00"W, 296.00 feet to the north line of the Walker Subdivision being a point 89.50 feet south of the Northeast corner of the South Half of said NE $\frac{1}{4}$; thence along the north line of the Walker Subdivision N89°37'52"W, 397.00 feet; thence N0°00'00"E, 69.00 feet; thence N89°37'52"W 128.01 feet; thence N0°00'00"E 223.62 feet; thence N90°00'00"E 525.00 feet to the point of beginning containing 3.34 acres more or less in McPherson County, Kansas and less the east 33 feet thereof for road right of way easement.

Melanie L. Thrower Liscenced Land Surveyor in the State of Kansas performed this survey on March 27, 2006.
This exhibit is a true representation of the survey.

Walker Subdivision Lot 1
Deed 262 pg. 432

East Quarter Cor. Sec. 19, T19S, R3W

Found $\frac{3}{8}$ Bar

Origin Unknown

1. 43.6' SE to top 4x4 post
2. 46.2' NE to power pole
3. 30.6' WSW to power pole
4. At center 13th Ave. in line with E-W hedge row