

LEGEND

- △ - Sectional Monument Found
- ▲ - Section Monument Set (5/8" x 24" Iron Rebar w/G.S.S. Cap)
- - Survey Monument Found
- - 5/8" x 24" Iron Rebar Set w/G.S.S. Cap
- (C) - Calculated
- (M) - Measured
- (PS) - Previous Survey by Francis D. Wagner 9/21/1955
- (PS) - Previous Survey by F. R. Rankin 3/1/1963
- (R) - Record measurement
- P.O.B. - Point of Beginning
- P.O.C. - Point of Commencement

DESCRIPTION:

PARCEL 1

A portion of the North Half of the Northeast Quarter of Section 19, Township 17 South, Range 5 West of the 6th Principal Meridian, McPherson County, Kansas described as follows:

Commencing at the Northeast corner of said Northeast Quarter; thence on a NAD 83 Kansas South Zone bearing of South 00°33'33" East on the East line of said Northeast Quarter a distance of 404.94 feet to the point of beginning; thence continuing South 00°33'33" East on said East line a distance of 912.34 feet to the Southeast corner of the North Half of said Northeast Quarter; thence North 89°43'27" West on the South line of said North Half a distance of 2644.20 feet to the Southwest corner of said North Half; thence North 00°45'41" West on the West line of said North Half a distance of 1319.12 feet to the Northwest corner of said Northeast Quarter; thence South 89°41'10" East on the North line of said Northeast Quarter a distance of 2243.94 feet to a point 404.94 feet West of the Northeast corner of said Northeast Quarter; thence South 00°33'33" East parallel with the East line of said Northeast Quarter a distance of 404.94 feet; thence South 89°41'10" East parallel with the North line of said Northeast Quarter a distance of 404.94 feet to the point of beginning.

Containing **76.314 Acres** and subject to Highway K 4 Right of Way along the North line thereof and a road right of way easement across the East 33.00 feet thereof, and any other easements or restrictions of record.

PARCEL 2

A portion of the North Half of the Northeast Quarter of Section 19, Township 17 South, Range 5 West of the 6th Principal Meridian, McPherson County, Kansas described as follows:

Commencing at the Northeast corner of said Northeast Quarter; thence on a NAD 83 Kansas South Zone bearing of South 00°33'33" East on the East line of said Northeast Quarter a distance of 208.71 feet (Record) to the point of beginning; thence continuing South 00°33'33" East on said East line a distance of 196.23 feet; thence North 89°41'10" West parallel with the North line of said Northeast Quarter a distance of 404.94 feet; thence North 00°33'33" West parallel with said East line a distance of 404.94 feet to said North line; thence South 89°41'10" East on said North line a distance of 196.23 feet to a point 208.71 feet (Record) West of the Northeast corner of said Northeast Quarter; thence South 00°33'33" East parallel with said East line a distance of 208.71 feet (Record); thence South 89°41'10" East parallel with said North line a distance of 208.71 feet (Record) to the point of beginning.

Containing **2.764 Acres** and subject to Highway K 4 Right of Way along the North line thereof and a road right of way easement across the East 33.00 feet thereof, and any other easements or restrictions of record.

SURVEYOR'S NOTES:

1. Found 2 sandstone fragments partially buried at ancient fence corner. Accepted as the corner monument and set 5/8" rebar with GSS cap in center of fragments.
2. Located the ancient East/West fence line along the South line of the North Half and accepted its position with consideration of the found sandstone fragments at the Southwest corner. Intersected line of fence with East line of the Northeast Quarter to establish the position of the Southeast corner.

SURVEYOR'S CERTIFICATE:

I hereby certify this plat to be a true, correct and complete representation of the property described hereon, as surveyed under my supervision, this 15th day of November, 2018.

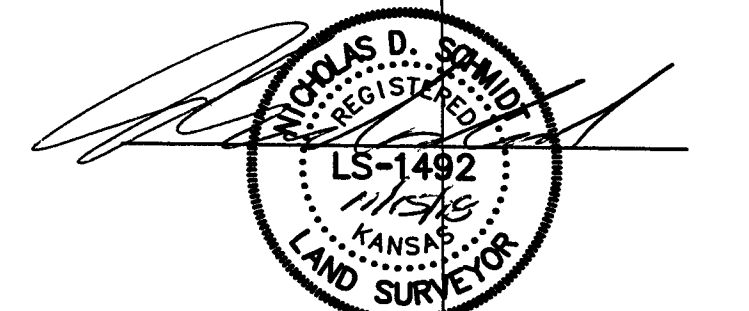

Prepared For: HORIZON FARM AND RANCH REALTY		Description: A PORTION OF THE N 1/2, NE 1/4 SECTION 19, T17S, R5W MCPHERSON COUNTY, KANSAS	
Prepared By: GSS		Garber Surveying Service, P.A.	
HUTCHINSON (Main Office) 2908 North Plum St. 67302 Ph. 620-665-7822 Fax 620-663-7401		McPHERSON (Branch Office) 115 East Marlin 67460 Ph. 620-241-4441 Fax 620-241-4458	
NEWTON (Branch Office) 511 North Poplar St. 67114 Ph. 316-283-5053 Fax 316-283-5073			
Drawn By: KDZ	Scale: 1"=200'	Date of Field Work: November 2, 2018	Job No: G2018-821
Checked By: NDS	Date: 11/15/2018	Sheet 1 of 1 Sheet(s)	