

**DESCRIPTION:
PARCEL 1**

A portion of the Fractional Southwest Quarter of Section 19, Township 17 South, Range 2 West of the 6th Principal Meridian, McPherson County, Kansas described as follows:

Beginning at the Southwest corner of the Fractional Southwest Quarter of Section 19, Township 17 South, Range 2 West of the 6th Principal Meridian; thence on a Kansas State Plane Zone 1502 Bearing North 00°38'58" West along the West line of said Southwest Quarter 1323.62 feet to the Northwest corner of the South Half of said Southwest Quarter; thence North 89°01'28" East along the North line of said South Half 220.00 feet; thence South 24°00'35" East 151.42 feet; thence South 00°55'24" East 181.10 feet; thence South 11°25'20" East 211.15 feet; thence South 57°10'03" East 102.23 feet; thence South 79°39'00" East 139.01 feet; thence South 25°46'59" East 164.43 feet; thence North 83°26'01" East 167.41 feet; thence South 22°05'22" East 212.41 feet; thence North 87°47'03" East 284.79 feet; thence South 05°04'28" East 383.11 feet to the South line of said Southwest Quarter; thence South 88°48'57" West along said South line 1170.37 feet to the point of beginning, containing 19.657 Acres, subject to a road right of way easements across the West 20.00 feet and South 50.00 feet thereof and any other easements or restrictions of record.

PARCEL 2

A portion of the Fractional Southwest Quarter of Section 19, Township 17 South, Range 2 West of the 6th Principal Meridian, McPherson County, Kansas described as follows:

Beginning at the Southeast corner of the Fractional Southwest Quarter of Section 19, Township 17 South, Range 2 West of the 6th Principal Meridian; thence on a Kansas State Plane Zone 1502 Bearing South 88°48'57" West along the South line of said Southwest Quarter 1357.87 feet to a point 1170.37 feet East of the Southwest corner of said Southwest Quarter; thence North 05°04'28" West 383.11 feet; thence South 87°47'03" West 284.79 feet; thence North 22°05'22" West 212.41 feet; thence South 83°26'01" West 167.41 feet; thence North 25°46'59" West 164.43 feet; thence South 79°39'00" West 139.01 feet; thence North 57°10'03" West 102.23 feet; thence North 11°25'20" West 211.15 feet; thence North 00°55'24" West 181.10 feet; thence North 24°00'35" West 151.42 feet to a point on the North line of the South Half of said Southwest Quarter, said point being 220.00 feet East of the Northwest corner of said North Half; thence North 89°01'28" East along said North line 2346.01 feet to the Northeast corner of said South Half; thence South 01°18'37" East along the East line of said Southwest Quarter 1314.42 feet to the point of beginning, containing 56.667 Acres, subject to a road right of way easement across the South 50.00 feet thereof and any other easements or restrictions of record.

PARCEL 3

A portion of the Fractional Southwest Quarter of Section 19, Township 17 South, Range 2 West of the 6th Principal Meridian, McPherson County, Kansas described as follows:

Commencing at the Northwest corner of the Fractional Southwest Quarter of Section 19, Township 17 South, Range 2 West of the 6th Principal Meridian; thence on a Kansas State Plane Zone 1502 Bearing South 00°38'58" East along the West line of said Southwest Quarter 888.00 feet to the point of beginning; thence North 89°21'02" East perpendicular to said West line 232.00 feet; thence South 18°43'35" East 72.28 feet; thence South 17°14'47" West 229.41 feet; thence South 05°53'37" West 148.62 feet to the South line of the North Half of said Southwest Quarter; thence South 89°01'28" West along said South line 167.00 feet to the Southwest corner of said North Half; thence North 00°38'58" West along said West line 435.62 feet to the point of beginning, containing 2.079 Acres, subject to a road right of way easement across the West 20.00 feet thereof and any other easements or restrictions of record.

PARCEL 4

A portion of the Fractional Southwest Quarter of Section 19, Township 17 South, Range 2 West of the 6th Principal Meridian, McPherson County, Kansas described as follows:

Commencing at the Northwest corner of the Fractional Southwest Quarter of Section 19, Township 17 South, Range 2 West of the 6th Principal Meridian; thence on a Kansas State Plane Zone 1502 Bearing South 00°38'58" East along the West line of said Southwest Quarter 460.93 feet to the point of beginning; thence South 84°44'33" East 412.88 feet; thence North 63°58'25" East 127.72 feet; thence North 07°11'15" East 454.10 feet to the North line of said Southwest Quarter; thence North 89°14'08" East along said North line 1909.81 feet to the Northeast corner of said Southwest Quarter; thence South 01°18'37" East along the East line of said Southwest Quarter 1314.42 feet to the Southeast corner of the North Half of said Southwest Quarter; thence South 89°01'28" West along the South line of said North Half 2346.01 feet; thence North 05°53'37" East 148.62 feet; thence North 17°14'47" East 229.41 feet; thence North 18°43'35" West 72.28 feet; thence South 89°21'02" West perpendicular to the West line of said Southwest Quarter 232.00 feet to said West line; thence North 00°38'58" West along said West line 427.07 feet to the point of beginning, containing 67.652 Acres, subject to a road right of way easement across the West 20.00 feet thereof and any other easements or restrictions of record.

PARCEL 5

A portion of the Fractional Southwest Quarter of Section 19, Township 17 South, Range 2 West of the 6th Principal Meridian, McPherson County, Kansas described as follows:

Beginning at the Northwest corner of the Fractional Southwest Quarter of Section 19, Township 17 South, Range 2 West of the 6th Principal Meridian; thence on a Kansas State Plane Zone 1502 Bearing North 89°14'08" East along the North line of said Southwest Quarter 588.00 feet; thence North 07°11'15" West 454.10 feet; thence South 63°58'25" West 127.72 feet; thence North 84°44'33" West 412.88 feet to the West line of said Southwest Quarter; thence North 00°38'58" West along said West line 460.93 feet to the point of beginning, containing 6.133 Acres, subject to a road right of way easement across the West 20.00 feet thereof and any other easements or restrictions of record.

SURVEYOR'S CERTIFICATE:

I hereby certify this plat to be a true, correct and complete representation of the property described hereon, as surveyed under my supervision, this 19th day of November, 2013.

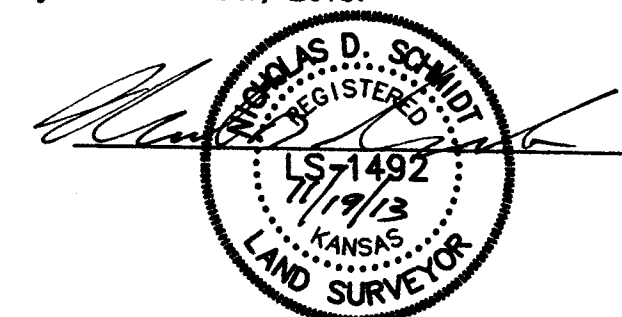

Prepared For: KRISTEN CARLSON	Description: PORTIONS OF THE SW 1/4 SECTION 19, T17S, R2W MCPHERSON COUNTY, KANSAS
Prepared By: GSS	Garber Surveying Service, P.A.
Drawn By: CSS	HUTCHINSON (Main Office) 2908 North Plum St. 67502 Ph. 620-465-7032 Fax 620-463-7401 MCPHERSON (Branch Office) 115 East Martin 67460 Ph. 620-241-4441 Fax 620-241-4458 NEWTON (Branch Office) 511 North Poplar St. 67114 Ph. 316-283-5053 Fax 316-283-5073
Checked By: NDS	Date: 11/19/2013 Sheet 1 of 1 Sheet(s)
Scale: 1"=150'	Date of Field Work: November 7, 2013 Job No: G2013-712