

LEGEND

- △ - Sectional Monument Found
- ▲ - Section Monument Set (5/8" x 24" Iron Rebar w/G.S.S. Cap)
- - Survey Monument Found
- - 5/8" x 24" Iron Rebar Set w/G.S.S. Cap
- (C) - Calculated
- (M) - Measured
- (PS) - Previous Survey GSS Project #2015-285

SURVEYOR'S CERTIFICATE:

I hereby certify this plat to be a true, correct and complete representation of the property described hereon, as surveyed under my supervision, this 18th day of November, 2021.

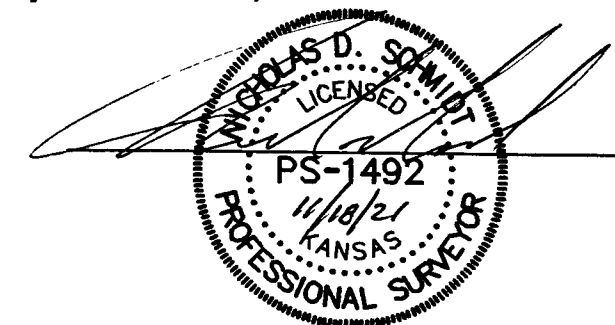

DESCRIPTION OF RECORD (BK. 667, PG. 86792):

- PARCEL 1**
Southeast Quarter of the Southwest Quarter of Section 18, Township 20 South, Range 1 West of the 6th P.M., McPherson County, Kansas.
- PARCEL 2**
West 15 acres of the Southwest Quarter of the Southeast Quarter of Section 18, Township 20 South, Range 1 West of the 6th P.M., McPherson County, Kansas.

Prepared For: CITIZENS STATE BANK		Description: A PORTION OF THE SE 1/4 AND SW 1/4 SECTION 18, T20S, R1W McPHERSON COUNTY, KANSAS	
Prepared By: GSS HUTCHINSON 2908 North Plum St. 67502 Ph. 620-665-7032 (Main Office)		Garber Surveying Service, P.A. BRANCH OFFICES: MCPHERSON Ph. 620-241-4441 SALINA Ph. 785-404-6302 MANHATTAN Ph. 785-320-4810 NEWTON Ph. 316-283-5053 WICHITA Ph. 316-260-9933	
Drawn By: GAQ	Scale: 1"=200'	Date of Field Work: November 12, 2021	Job No: G2021-1166
Checked By: NDS	Date: 11/18/2021	Sheet 1 of 1 Sheet(s)	