

-200 0 200 400 600

BASIS OF BEARING = NAD 83 KANSAS SOUTH ZONE

DESCRIPTION OF RECORD:

(Bk. 264, Pg. 305)

Part of the Southeast Quarter (SE/4) of section Seventeen (17), Township Twenty-one (21) South, Range Four (4) West of the 6th P.M. described as follows:

Beginning at the Northwest corner of said SE/4, thence East 80 Rods, thence South 106 Rods, thence West 80 Rods, thence North 106 Rods to point of beginning, except the Right-of-way of the Chicago, Rock Island and Pacific Railroad and except land condemned for highway purposes and

A strip of land in the Southwest Quarter of the Southeast Quarter (SW/4 SE/4) of Section Seventeen (17), Township Twenty-one (21) South, Range Four (4) West of the 6th P.M. described as follows:

Beginning at the Southeast corner of said SW/4 SE/4, thence North 54 rods, thence West 1 Rod; thence South 54 Rods, thence East 1 Rod to point of beginning.

(Bk. 660, Pg. 3053)

A tract of land in the Southeast Quarter of Section 17, Township 21, Range 4 West of the 6th P.M., described as follows:

BEGINNING at the Northwest corner of said Quarter Section; FIRST COURSE, thence on an assumed bearing of South 00 degrees 44 minutes 49 seconds East 856.46 feet along the West line of said Quarter Section to the Westerly right of way line of the Union Pacific Railway; SECOND COURSE, thence North 30 degrees 36 minutes 11 seconds East, 1002.44 feet along said right of way line to the North line of said Quarter Section; THIRD COURSE, thence South 89 degrees 17 minutes 41 seconds West, 521.53 feet along said North line to the POINT OF BEGINNING. The above described tract contains 5.13 acres, more or less

SURVEYOR'S CERTIFICATE:

I hereby certify this plat to be a true, correct and complete representation of the property described hereon, as surveyed under my supervision, this 22nd day of March, 2022.

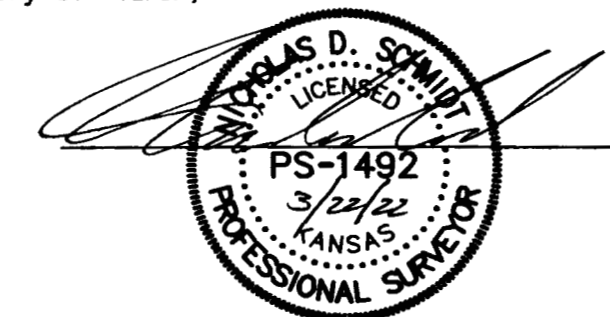

Prepared For:	Description: A PORTION OF THE SE 1/4 SECTION 17, T21S, R4W McPHERSON COUNTY, KANSAS		
Prepared By:	Garber Surveying Service, P.A.		
	HUTCHINSON		
	2908 North Plum St. 67502 Ph. 620-665-7032 (Main Office)		
BRANCH OFFICES:		MANHATTAN Ph. 785-320-4810	
		MCPHERSON Ph. 620-241-4441	NEWTON Ph. 316-283-5053
		SALINA Ph. 785-404-6302	WICHITA Ph. 316-260-9933
Drawn By: KDZ	Scale: 1"=200'	Date of Field Work: February 25, 2022	Job No:
Checked By: NDS	Date: 03/22/2022	Sheet 1 of 1 Sheet(s)	G2022-145