

- LEGEND**
- △ - Sectional Monument Found
 - ▲ - Section Monument Set (5/8" x 24" Iron Rebar w/G.S.S. Cap)
 - - Survey Monument Found
 - - 5/8" x 24" Iron Rebar Set w/G.S.S. Cap
 - (C) - Calculated
 - (M) - Measured
 - (PS) - Previous Survey by LS 752 Dated 6/29/05
 - (R) - Record Measurement
 - P.O.B. - Point of Beginning
 - P.O.C. - Point of Commencement

DESCRIPTION OF RECORD (BK 407, PG. 59):
Part of the East 1/2 of East 1/2 of West 1/2 of Northeast 1/4 of Section 17, Township 20 South, Range 2 East, more particularly described as follows: Beginning at the Northwest corner of said East 1/2 of East 1/2 of West 1/2 of Northeast 1/4, thence East 148 feet; thence South 491 feet; thence West 148 feet; thence North 491 feet to place of beginning.

DESCRIPTION OF RECORD (BK 407, PG. 60):
All that part of the North 525 feet of the East 1/2 of the East 1/2 of the West 1/2 of the Northeast 1/4 of Section 17, Township 20 South, Range 2 East, lying West 1/2 of the following described line: Beginning on the North line of said East 1/2 of East 1/2 West 1/2 Northeast 1/4 at a point 1500.00 feet West of the Northeast corner of said Northeast 1/4, thence South at right angles to said North line for a distance of 525 feet and there ending; and EXCEPT the following described tract: Beginning at the Northwest corner of said E/2 E/2 W/2 NE/4, thence East 148 feet; thence South 491 feet; thence West 148 feet; thence North 491 feet to place of beginning.

SURVEY DESCRIPTION:
A portion of the East Half of the East Half of the West Half of the Northeast Quarter of Section 17, Township 20 South, Range 2 East of the 6th Principal Meridian, Marion County, Kansas described as follows:
Commencing at the Northeast Corner of Section 35, Township 20 South, Range 2 West of the 6th Principal Meridian; thence on a Kansas State Plane Grid Bearing South 88°58'08" West along the North line of said Northeast Quarter 1500.00 feet to the point of beginning; thence South 01°01'52" East perpendicular to said North line 525.00 feet; thence South 88°58'08" East parallel with said North line 154.90 feet to the West line of the East Half of the East Half of the West Half of said Northeast Quarter; thence North 00°50'51" West along said West line 525.00 feet to the Northwest corner of said East Half of the East Half of the West Half of the Northeast Quarter; thence North 88°58'08" East along the North line of said Northeast Quarter 153.22 feet to the point of beginning, containing 1.857 Acres, subject to a road right of way easement across the North 25.00 feet thereof and any other easements or restrictions of record.

SURVEYOR'S NOTES:
1) Calculated position of the West 1/4 corner falls in the un-maintained roadway. Searched for GLO stone by did not find. Deemed corner to be lost and reset by single proportionate measurement on line between NW and SW section corners. Road grade appears to be 5 feet below grade on either side.
2) Calculated position of the South 1/4 corner falls in the center of an old concrete box culvert. No physical evidence available to reset the monument so deemed as lost and reset by single proportionate measurement between the SW and SE section corners. Set Mag nail in top of concrete box culvert.

SURVEYOR'S CERTIFICATE:
I hereby certify this plat to be a true, correct and complete representation of the property described hereon, as surveyed under my supervision, this 14th day of February, 2013.

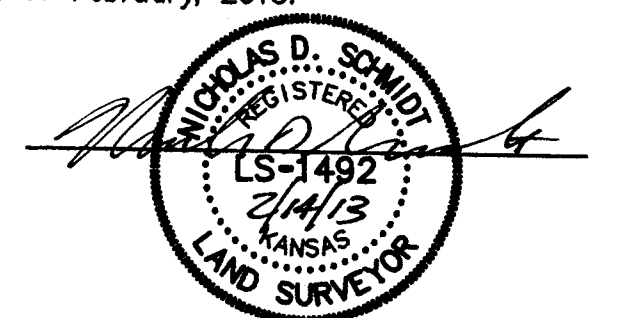

Prepared For: LINDA FRIEND	Description: A PORTION OF THE NE 1/4 SECTION 17, T20S, R2E MARION COUNTY, KANSAS		
Prepared By: GSS	Garber Surveying Service, P.A.		
HUTCHINSON (Main Office) 2908 North Plum St. 67502 Ph. 620-465-7032 Fax 620-463-7401 McPHERSON (Branch Office) 115 East Marlin 67460 Ph. 620-241-4441 Fax 620-241-4458 NEWTON (Branch Office) 511 North Poplar St. 67114 Ph. 316-283-5053 Fax 316-283-5073			
Drawn By: KLL	Scale: 1"=50'	Date of Field Work: January 14, 2013	Job No:
Checked By: NDS	Date: 02/14/2013	Sheet 1 of 1 Sheet(s)	G2012-754