

A SURVEY OF THE NORTH LINE
OF THE SE 1/4 SECTION 17,
TOWNSHIP 18S, RANGE 5 W
MC PHERSON COUNTY, KANSAS

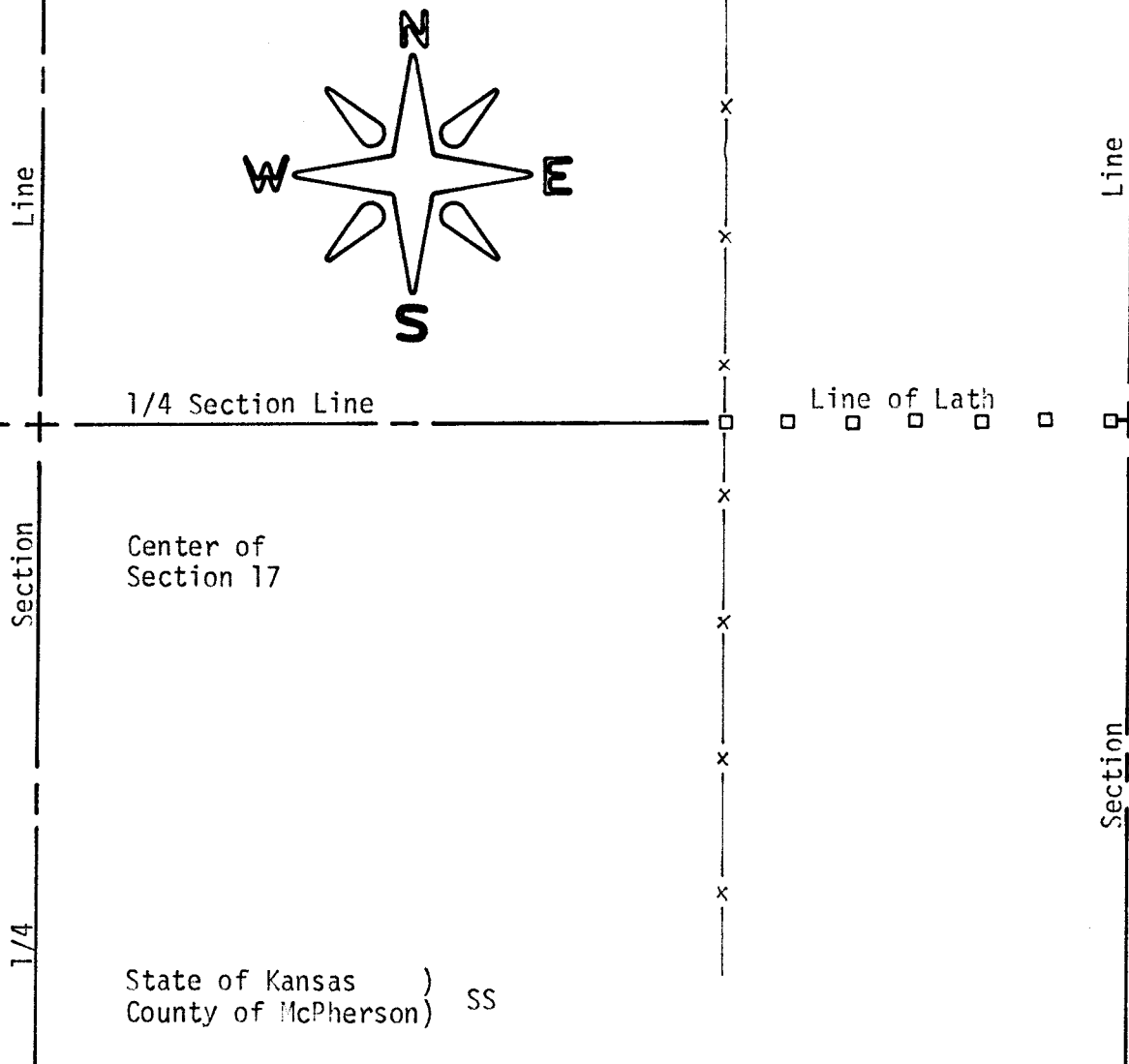

I, F. R. Rankin, County Engineer of McPherson County, Kansas, do hereby certify that under my supervision a survey was made of the North line of the SE 1/4 of Section 17, T18S, R5W of the 6th P.M. The above plat is a true exhibit of said survey as far as it is known to me.

Survey called for by Max Teeter

Signed this 20 day of March, 1972

F. R. Rankin
F. R. Rankin, P. E.
County Engineer
McPherson County, Kansas

