

WELLS FARGO ROAD

N 89°45'27" E 2644.77 (M)(PS)

P.O.C.

N 89°45'27" E 779.00 (C)(R)(PS)
759.00 (C)(R)(PS)

NE Cor. NW 1/4
Sec. 16, T17S, R3W
Fd. Mag Nail
Origin: (PS)

NW Cor. NW 1/4
Sec. 16, T17S, R3W
Fd. "+" in Conc.
Origin: (PS)

LEGEND

- △ - Sectional Monument Found
- - Fd. 1/2" Rebar w/LS 1202 Cap unless otherwise noted
- - 5/8" x 24" Iron Rebar Set w/GSS CLS 52 Cap
- (C) - Calculated
- (M) - Measured
- (PL) - Platted
- (PS) - Previous Survey by LS 1202 1/18/2016
- (PS1) - Previous Survey by Forgy-Allen 1/28/1952
- (R) - Record measurement
- P.O.B. - Point of Beginning
- P.O.C. - Point of Commencement

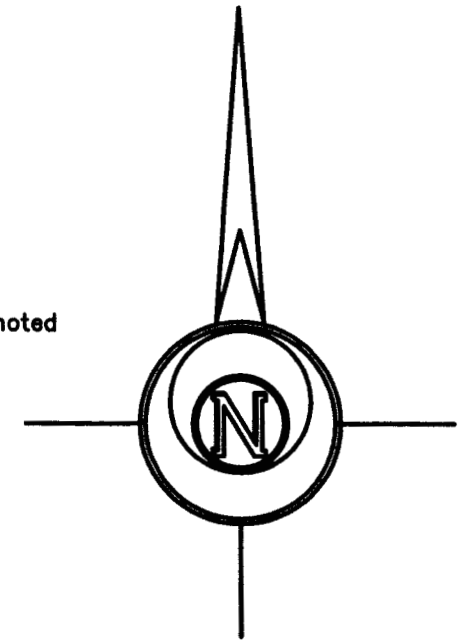

-200 0 200 400 600

DESCRIPTION:

BASIS OF BEARING = NAD 83 KANSAS SOUTH ZONE

PARCEL 1

A portion of the Northwest Quarter of Section 16, Township 17 South, Range 3 West of the 6th Principal Meridian, McPherson County, Kansas described as follows:

Commencing at the Northeast corner of said Northwest Quarter; thence on a NAD 83 Kansas South Zone bearing of South 89°45'27" West on the North line of said Northwest Quarter a distance of 779.00 feet (Record); thence South 00°50'50" East parallel with the East line of said Northwest Quarter a distance of 1268.44 feet (Record) to the Southeast corner of a parcel described in Book 663, Page 2538 at the McPherson County Register of Deeds Office; thence South 89°45'27" West on the South line of said parcel a distance of 653.97 feet to the point of beginning; thence continuing South 89°45'27" West on said South line a distance of 1160.57 feet to the Southwest corner of said parcel; thence North 01°14'43" West on the West line of said parcel a distance of 20.13 feet to the Northwest corner of said parcel; thence North 89°45'27" East on the North line of said parcel a distance of 377.22 feet to the centerline of vacated Jackson Street of Eberhardt's Addition to the City of Lindsborg; thence North 01°14'01" West on said centerline a distance of 18.08 feet; thence South 89°11'58" East a distance of 784.15 feet; thence South 00°14'33" East a distance of 23.92 feet to the point of beginning.

Containing 0.733 Acre and subject to any easements or restrictions of record.

PARCEL 2

A portion of the Northwest Quarter of Section 16, Township 17 South, Range 3 West of the 6th Principal Meridian, McPherson County, Kansas described as follows:

Commencing at the Northeast corner of said Northwest Quarter; thence on a NAD 83 Kansas South Zone bearing of South 89°45'27" West on the North line of said Northwest Quarter a distance of 779.00 feet (Record); thence South 00°50'50" East parallel with the East line of said Northwest Quarter a distance of 1268.44 feet (Record) to the Southeast corner of a parcel described in Book 663, Page 2538 at the McPherson County Register of Deeds Office, being the point of beginning; thence North 89°45'27" East on the extended South line of said parcel a distance of 20.00 feet to a point 759.00 feet West of said East line; thence South 00°50'50" East parallel with said East line a distance of 47.38 feet; thence South 89°45'27" West parallel with the South line of said parcel a distance of 674.47 feet; thence North 00°14'33" West perpendicular to said South line a distance of 47.38 feet to said South line; thence North 89°45'27" East on said South line a distance of 653.97 feet to the point of beginning.

Containing 0.733 Acre and subject to any easements or restrictions of record.

SURVEYOR'S CERTIFICATE:

I hereby certify this plat to be a true, correct and complete representation of the property described hereon, as surveyed under my supervision, this 23rd day of August, 2019.

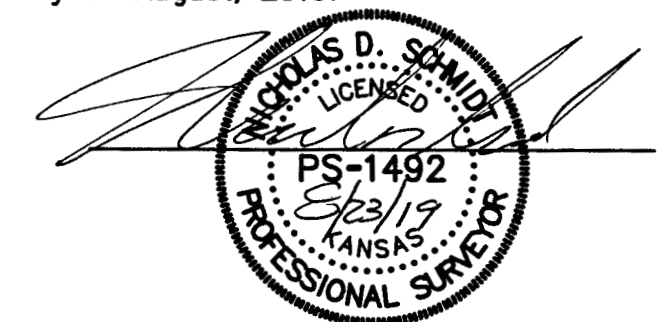

Prepared For:		Description:	
CHRIS SHORT		A PORTION OF THE NW 1/4 SECTION 16, T17S, R3W McPHERSON COUNTY, KANSAS	
Prepared By:		Garber Surveying Service, P.A.	
GSS		HUTCHINSON (Main Office) 2908 North Plum St. 67502 Ph. 620-665-7032 Fax 620-663-7401 McPHERSON (Branch Office) 115 East Marlin 67460 Ph. 620-241-4441 Fax 620-241-4458 NEWTON (Branch Office) 511 North Poplar St. 67114 Ph. 316-283-5053 Fax 316-283-5073 MANHATTAN (Branch Office) 3226 Kimball Ave Ste. #2 66503 Ph. 785-320-4810	
Drawn By:	KDZ	Scale:	1"=200'
Checked By:	NDS	Date of Field Work:	August 19, 2019
		Sheet 1 of 1 Sheet(s)	Job No:
			G2019-566

NORTH HARRISON STREET

OWNER: JOHN C. AND LISA K. SHORT TRUSTS
(Bk. 663, Pg 2538 and Bk. 651, Pg. 4065)

OWNER: DONALD DAUER REV. TRUST
(Bk. 663, Pg 1)

PARCEL 1
SEE DETAIL 1

PARCEL 2
SEE DETAIL 2

Lindsborg Cemetery (PS)

Lindsborg Cemetery (PS)

SE Cor. NW 1/4
Sec. 16, T17S, R3W
Fd. 1/2" Rebar in a Pipe
Origin: (PS)

SW Cor. NW 1/4
Sec. 16, T17S, R3W
Fd. "+" in Conc.
Origin: (PS)

