

- LEGEND**
- △ - Sectional Monument Found
 - - 5/8" x 24" Iron Rebar Set w/GSS CLS 52 Cap
 - (C) - Calculated
 - (M) - Measured
 - (PS) - Previous Survey GSS Project #2016-516
 - P.O.B. - Point of Beginning
 - P.O.C. - Point of Commencement

DESCRIPTION OF RECORD (PARENT PARCEL):

The North Half of the North Half of the Southeast Quarter and the North Half of the South Half of the North Half of the Southeast Quarter, all in Section 15, Township 20 South, Range 2 West of the 6th Principal Meridian, McPherson County, Kansas.

DESCRIPTION:

A portion of the North Half of the Southeast Quarter of Section 15, Township 20 South, Range 2 West of the 6th Principal Meridian, McPherson County, Kansas described as follows:

Commencing at the Northeast corner of said Southeast Quarter; thence on a NAD 83 Kansas South Zone bearing of South 00°48'31" East on the East line of said Southeast Quarter a distance of 629.14 feet to the point of beginning; thence continuing South 00°48'31" East on said East line a distance of 40.01 feet; thence South 87°56'48" West a distance of 408.49 feet; thence South 00°48'31" East parallel with said East line a distance of 185.34 feet; thence South 89°11'29" West perpendicular to said East line a distance of 475.00 feet; thence North 00°48'31" West parallel with said East line a distance of 650.00 feet; thence North 89°11'29" East perpendicular to said East line a distance of 475.00 feet; thence South 00°48'31" East parallel with said East line a distance of 424.65 feet; thence North 87°56'48" East a distance of 408.49 feet to the point of beginning.

Containing 7.463 Acres and subject to a road right of way easement across the East 30.00 feet thereof, and any other easements or restrictions of record.

SURVEYOR'S CERTIFICATE:

I hereby certify this plat to be a true, correct and complete representation of the property described hereon, as surveyed under my supervision, this 9th day of January, 2019.

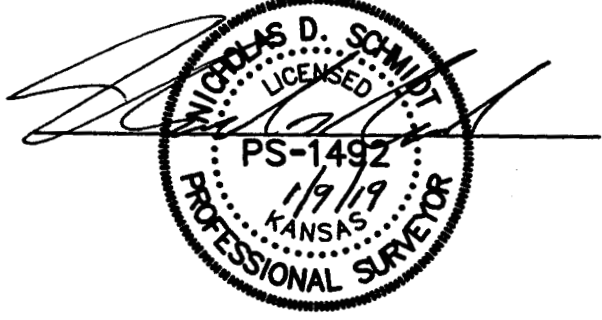

Prepared For:		Description:	
ALLEN NIGHTINGALE		A PORTION OF THE N 1/2, SE 1/4 SECTION 15, T20S, R2W McPHERSON COUNTY, KANSAS	
Prepared By:		Garber Surveying Service, P.A.	
GSS		HUTCHINSON (Main Office) 2908 North Plum St. 67502 Ph. 620-665-7032 Fax 620-663-7401	
		McPHERSON (Branch Office) 115 East Martin 67460 Ph. 620-241-4441 Fax 620-241-4458	
		NEWTON (Branch Office) 511 North Poplar St. 67114 Ph. 316-283-5053 Fax 316-283-5073	
		MANHATTAN (Branch Office) 3226 Kimball Ave Ste.#2 66503 Ph. 785-320-4810	
Drawn By:	KDZ	Scale: 1"=60'	Date of Field Work: January 4, 2019
Checked By:	NDS	Date: 01/09/2019	Sheet 1 of 1 Sheet(s)
			Job No: G2019-3