

LEGEND

- Sectional Monument Found
- Section Monument Set (5/8" x 24" Iron Rebar w/G.S.S. Cap)
- Sectional Monument Calculated
- 5/8" x 24" Iron Rebar Set w/G.S.S. Cap
- Power Pole
- Calculated
- Measured
- Previous Survey by LS 697 (5/24/2000)
- General Land Office

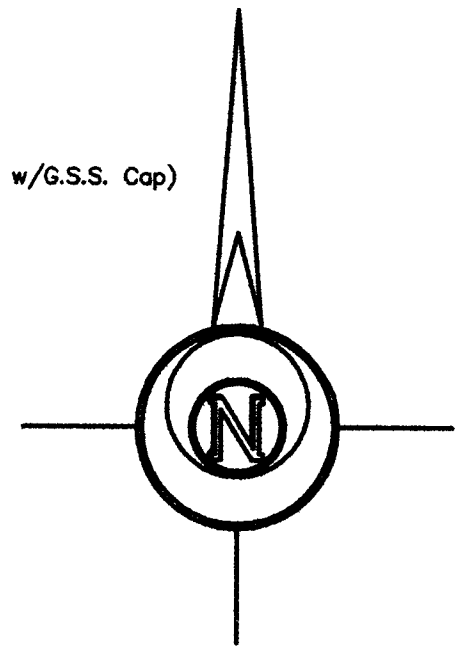

BASIS OF BEARING = NAD 83 KANSAS SOUTH ZONE

DESCRIPTION:

A portion of the South Half of the South Half of the Southeast Quarter of Section 15, Township 20 South, Range 2 West of the 6th Principal Meridian, McPherson County, Kansas described as follows:

Commencing at the Southeast corner of said Southeast Quarter; thence on a NAD 83 Kansas South Zone bearing of North 00°48'31" West on the East line of said Southeast Quarter a distance of 229.86 feet to the point of beginning; thence South 88°55'47" West a distance of 514.16 feet; thence South 77°23'33" West a distance of 90.61 feet; thence South 89°12'06" West a distance of 121.00 feet; thence North 01°08'36" East a distance of 446.72 feet to the North line of the South Half of the South Half of said Southeast Quarter; thence North 89°11'57" East on said North line a distance of 708.64 feet to the Northeast corner of the South Half of the South Half of said Southeast Quarter; thence South 00°48'31" East on said East line a distance of 425.51 feet to the point of beginning.

Containing 7.089 Acres and subject to a road right of way easement across the East 33.00 feet thereof, and any other easements or restrictions of record.

PROPOSED ELECTRIC EASEMENT

A proposed Electric Easement over and across a strip of land 20.00 feet in width, located on a portion of the Southeast Quarter of Section 15, Township 20 South, Range 02 West of the 6th Principal Meridian, McPherson County, Kansas, the centerline of which is more particularly described as follows:

Commencing at the Southeast corner of said Southeast Quarter; thence on a NAD 83 Kansas South Zone bearing of South 89°10'53" West on the South line of said Southeast Quarter a distance of 615.18 feet to the point of beginning; thence North 02°44'45" East a distance of 209.46 feet to the point of termination.

SURVEYOR'S CERTIFICATE:

I hereby certify this plat to be a true, correct and complete representation of the property described hereon, as surveyed under my supervision, this 19th day of August, 2016.

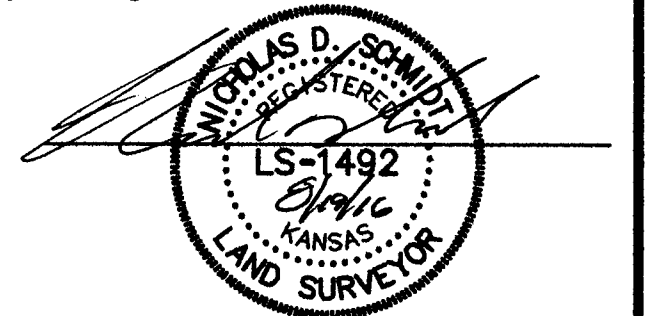

Prepared For: MELVERN AND ERMA GOERING ESTATE		Description: A PORTION OF THE SE 1/4 SECTION 15, T20S, R2W McPHERSON COUNTY, KANSAS	
Prepared By: GSS		Garber Surveying Service, P.A.	
HUTCHINSON (Main Office) 2908 North Plum St. 67502 Ph. 620-665-7032 Fax 620-663-7401		McPHERSON (Branch Office) 115 East Marlin 67460 Ph. 620-241-4441 Fax 620-241-4458	
NEWTON (Branch Office) 511 North Poplar St. 67114 Ph. 316-283-5053 Fax 316-283-5073			
Drawn By: SLW	Scale: 1"=100'	Date of Field Work: August 15, 2016	Job No:
Checked By: DEG	Date: 08/19/2016	Sheet 1 of 1 Sheet(s)	G2016-516