

A portion of the Southeast Quarter of Section 15, Township 19 South, Range 1 West of the 6th Principal Meridian, McPherson County, Kansas described as follows:

Commencing at the Southeast corner of the Southeast Quarter of Section 15, Township 19 South, Range 1 West of the 6th Principal Meridian; thence on a Kansas State Plane South Zone bearing of South 88°49'07" West along the South line of said Southeast Quarter 1776.00 feet (1776.00 Record) to the Southwest corner of a parcel described in Book 173, Page 319 in McPherson County, Kansas, said corner also being the point of beginning; thence continuing South 88°49'07" West along said South line 25.00 feet; thence North 01°10'53" West parallel with the West line of said parcel described in Book 173, Page 319 a distance of 942.00 feet; thence North 88°49'07" East parallel with said the South line of said Southeast Quarter 25.00 feet to the Northwest corner of a parcel described in Book 173, Page 317 in McPherson County, Kansas; thence South 01°10'53" East along the West lines of said parcels described in Book 173, Page 317 and Book 173, Page 319 a distance of 942.00 feet (942.00 Record) to the point of beginning, containing **0.541 Acre** and subject to a road right of way easement across the South 35.00 feet thereof and any other easements of record.

A portion of the Southeast Quarter of Section 15, Township 19 South, Range 1 West of the 6th Principal Meridian, McPherson County, Kansas described as follows:

Commencing at the Southeast corner of the Southeast Quarter of Section 15, Township 19 South, Range 1 West of the 6th Principal Meridian; thence on a Kansas State Plane South Zone bearing of South 88°49'07" West along the South line of said Southeast Quarter 1716.00 feet (1716.00 Record) to the Southeast corner of a parcel described in Book 173, Page 319 in McPherson County, Kansas, said corner also being the point of beginning; thence continuing South 88°49'07" West along said South line 25.00 feet; thence North 01°10'53" West parallel with the East line of said parcel described in Book 173, Page 319 a distance of 942.00 feet to the North line of a parcel described in Book 99, Page 583 in McPherson County, Kansas; thence North 88°49'07" East along said North line 25.00 feet to the Northwest corner of a parcel described in Book 646, Page 6878 in McPherson County, Kansas; thence South 01°10'53" East along the West line of said parcel described in Book 646, Page 6878 and the East line of said parcel described in Book 173, Page 319 a distance of 942.00 feet (942.00 Record) to the point of beginning, containing 0.541 Acres and subject to a road right of way easement across the South 33.00 feet thereof and any other easements of record.

I hereby certify this plat to be a true, correct and complete representation of the property described hereon, as surveyed under my supervision, this 20th day of December, 2011.

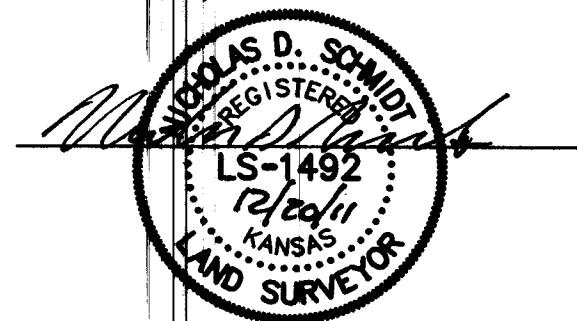

Prepared For: CITY OF CANTON		Description: A PORTION OF THE SE 1/4 SEC. 15, T19S, R1W McPHERSON COUNTY, KS.	
Prepared By: 		Garber Surveying Service, P.A. 2908 North Plain St. Hutchinson, Kansas 67502 Phone (620) 665-7032 • FAX (620) 663-7401	
		115 E. Marlin, Ste. 102 McPherson, Kansas 67460 Phone (316) 283-5053 • FAX (316) 283-5073	
Drawn By: AL	Scale: 1"=100'	Date of Field Work: November 21, 2011	Job No: G2011-647
Checked By: NDS	Date: 12/20/2011	Sheet 2 of 2 Sheet(s)	