

LEGEND

- △ - Sectional Monument Found
- ▲ - Section Monument Set (5/8" x 24" Iron Rebar w/GSS CLS 52 Cap)
- - 5/8" x 24" Iron Rebar Set w/GSS CLS 52 Cap
- - Fd. 5/8" Rebar w/GSS CLS 52 Cap
- × - Calculated Measurement - No Monument Set
- (C) - Calculated
- (M) - Measured
- (PS) - Previous Survey GSS Project #G2011-647
- (PS1) - Previous Survey Permanent Survey #106 by G.D. Johnson 4/27/1953
- P.O.B. - Point of Beginning
- P.O.C. - Point of Commencement

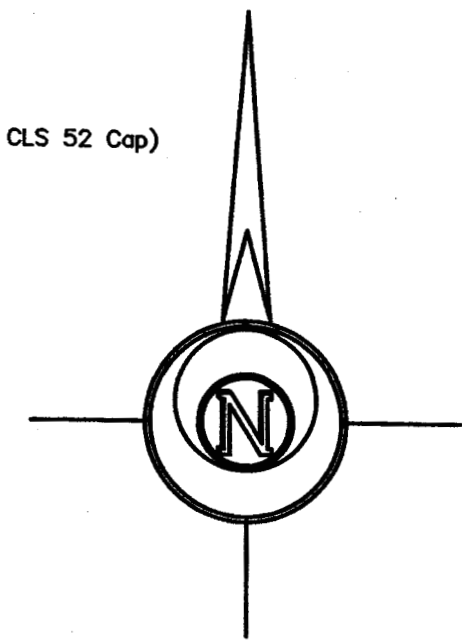

-100 0 100 200 300

BASIS OF BEARING = NAD 83 KANSAS SOUTH ZONE

DESCRIPTION:

TRACT 1

A portion of the Southwest Quarter of the Southeast Quarter of Section 15, Township 19 South, Range 1 West of the 6th Principal Meridian, McPherson County, Kansas, described as follows by Nicholas D. Schmidt, PS #1492, this 4th day of October, 2022:

Beginning at the Southwest corner of said Southeast Quarter; thence on a NAD 83 Kansas South Zone bearing of thence North 00°58'54" West on the West line of said Southeast Quarter a distance of 1328.57 feet to the Northwest corner of said Southwest Quarter of the Southeast Quarter; thence North 88°56'49" East on the North line of said Southwest Quarter of the Southeast Quarter a distance of 812.85 feet to the West line of a parcel described in Book 659, Page 1036 at the McPherson County Register of Deeds Office; thence South 00°59'16" East on said West line a distance of 384.77 feet; thence South 88°49'18" West on said West line a distance of 2.04 feet; thence South 01°10'46" East on said West line a distance of 632.00 feet; thence South 88°56'46" West a distance of 424.24 feet; thence South 54°57'56" West a distance of 163.32 feet; thence South 84°42'41" West a distance of 99.55 feet; thence South 00°11'03" East a distance of 212.84 feet to the South line of said Southeast Quarter; thence South 88°49'14" West on said South line a distance of 151.24 feet to the point of beginning.

Containing 20.42 Acres and subject to a road right of way easement along the South line thereof, and any other easements or restrictions of record.

TRACT 2

A portion of the Southwest Quarter of the Southeast Quarter of Section 15, Township 19 South, Range 1 West of the 6th Principal Meridian, McPherson County, Kansas, described as follows by Nicholas D. Schmidt, PS #1492, this 4th day of October, 2022:

Commencing at the Southwest corner of said Southeast Quarter; thence on a NAD 83 Kansas South Zone bearing of North 88°49'14" East on the South line of said Southeast Quarter a distance of 151.24 feet to the point of beginning; thence North 00°11'03" West a distance of 212.84 feet; thence North 84°42'41" East a distance of 99.55 feet; thence North 54°57'56" East a distance of 163.32 feet; thence North 88°56'46" East a distance of 424.24 feet to the West line of a parcel described in Book 659, Page 1036 at the McPherson County Register of Deeds Office; thence South 01°10'46" East on said West line a distance of 310.00 feet to said South line; thence South 88°49'14" West on said South line a distance of 662.86 feet to the point of beginning.

Containing 4.35 Acres and subject to a road right of way easement along the South line thereof, and any other easements or restrictions of record.

SURVEYOR'S CERTIFICATE:

I hereby certify this plat to be a true, correct and complete representation of the property described hereon, as surveyed under my supervision, this 7th day of October, 2022

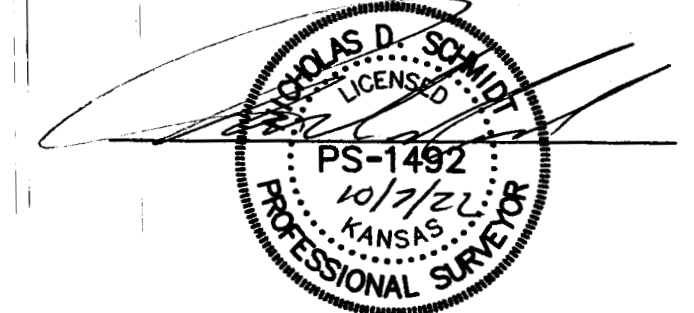

Prepared For:	CITIZENS STATE BANK			Description:	A PORTION OF THE SW 1/4, SE 1/4 SECTION 15, T19, R1W McPHERSON COUNTY, KANSAS	
Prepared By:	Garber Surveying Service, P.A.			Drawn By:	KDZ	Scale: 1"=100'
	HUTCHINSON 2908 North Plum St. 67502 Ph. 620-665-7032 (Main Office)			Date of Field Work:	September 26, 2022	Job No: G2022-780
	BRANCH OFFICES: MCPHERSON Ph. 620-241-4441 SALINA Ph. 785-404-6302 MANHATTAN Ph. 785-320-4810 NEWTON Ph. 316-283-5053 WICHITA Ph. 316-260-9933			Checked By:	NDS	Date: 10/07/2022
						Sheet 1 of 1 Sheet(s)

SURVEYOR'S NOTE:

- Survey was made as per client request and no title work has been provided to the surveyor; therefore, the number and extent of easements and/or rights-of-way of record affecting said property has not been verified by this Survey.