

DESCRIPTION:

PARCEL 1

A portion of the Northeast Quarter of Section 14, Township 20 South, Range 4 West of the 6th Principal Meridian, McPherson County, Kansas described as follows:

Beginning at the Northeast corner of said Northeast Quarter; thence on a NAD 83 Kansas South Zone bearing of thence on a NAD 83 Kansas South Zone bearing of South 00°23'16" East on the East line of said Northeast Quarter a distance of 716.58 feet; thence North 89°18'04" West parallel with the North line of said Northeast Quarter a distance of 1506.30 feet; thence North 00°40'20" West a distance of 56.47 feet to the South line of a parcel described in Book 651, Page 7446 at the McPherson County Register of Deeds Office; thence South 89°18'04" East on said South line a distance of 47.61 feet to the Southeast corner of said parcel; thence North 0°41'56" East on the East line of said parcel a distance of 660.00 feet to the North line of said Northeast Quarter; thence South 89°18'04" East on said North line a distance of 1446.46 feet to the point of beginning.

Containing 23.963 Acres and subject to road right of way easements across the North and East 33.00 feet thereof, and any other easements or restrictions of record.

PARCEL 2

A portion of the Northeast Quarter of Section 14, Township 20 South, Range 4 West of the 6th Principal Meridian, McPherson County, Kansas described as follows:

Commencing at the Northwest corner of said Northeast Quarter; thence on a NAD 83 Kansas South Zone bearing of South 89°18'04" East on the North line of said Northeast Quarter a distance of 907.50 feet to the Northwest corner of a parcel recorded in Book 651, Page 7446 at the McPherson County Register of Deeds Office; thence continuing South 89°18'04" East on said North line a distance of 73.62 feet to the point of beginning; thence continuing South 89°18'04" East on said North line a distance of 256.38 feet to the Northwest corner of said parcel; thence South 00°41'56" West on the East line of said parcel a distance of 660.00 feet to the Southeast corner of said parcel; thence North 89°18'04" West on the South line of said parcel a distance of 47.61 feet; thence North 00°40'20" West a distance of 376.02 feet; thence North 89°18'04" West parallel with said North line a distance of 199.78 feet; thence North 0°41'56" East perpendicular to said North line a distance of 284.09 feet to the point of beginning.

Containing 2.122 Acres and subject to a road right of way easement across the North 33.00 feet thereof, and any other easements or restrictions of record.

PARCEL 3

A portion of the Northeast Quarter of Section 14, Township 20 South, Range 4 West of the 6th Principal Meridian, McPherson County, Kansas described as follows:

Commencing at the Northwest corner of said Northeast Quarter; thence on a NAD 83 Kansas South Zone bearing of South 89°18'04" East on the North line of said Northeast Quarter a distance of 907.50 feet to the Northwest corner of a parcel recorded in Book 651, Page 7446 at the McPherson County Register of Deeds Office, being the point of beginning; thence continuing South 89°18'04" East on said North line a distance of 73.62 feet; thence South 00°41'56" West perpendicular to said North line a distance of 284.09 feet; thence South 89°18'04" East parallel with said North line a distance of 199.78 feet; thence South 00°40'20" East a distance of 376.02 feet to the South line of said parcel; thence North 89°18'04" West on said South line a distance of 282.39 feet to the Southwest corner of said parcel; thence North 00°41'56" East on the West line of said parcel a distance of 660.00 feet to the point of beginning.

Containing 2.878 Acres and subject to a road right of way easement across the North 33.00 feet thereof, and any other easements or restrictions of record.

NOTE:

Survey was made as per client request and no title work has been provided to the surveyor; therefore, the number and extent of easements and/or rights-of-way of record affecting the surveyed property has not been addressed by this survey.

SURVEYOR'S CERTIFICATE:

I hereby certify this plat to be a true, correct and complete representation of the property described hereon, as surveyed under my supervision, this 29th day of May, 2020.

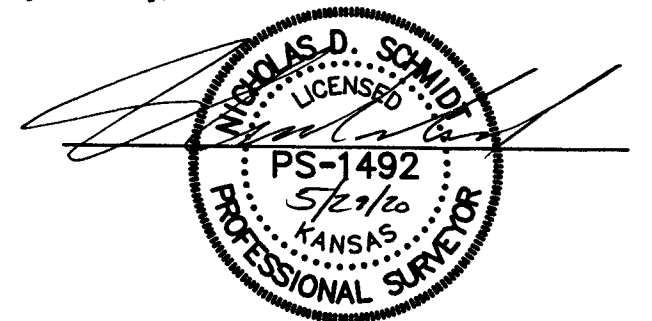

Prepared For:		Description:	
DOUG SAWYER		A PORTION OF THE NE 1/4 SECTION 14, T20S, R04W McPHERSON COUNTY, KANSAS	
Prepared By:		Garber Surveying Service, P.A.	
GSS		HUTCHINSON (Main Office) 2908 North Plum St. 67502 Ph. 620-665-7032 Fax 620-663-7401 McPHERSON (Branch Office) 115 East Martin 67460 Ph. 620-241-4441 Fax 620-241-4458 NEWTON (Branch Office) 511 North Poplar St. 67114 Ph. 316-283-5053 Fax 316-283-5073 MANHATTAN (Branch Office) 3226 Kimball Ave Ste.#2 66503 Ph. 785-320-4810	
Drawn By: KDZ	Scale: 1"=100'	Date of Field Work: May 20, 2020	Job No:
Checked By: NDS	Date: 05/29/2020	Sheet 1 of 1 Sheet(s)	G2020-362