

A SURVEY OF A TRACK OF LAND IN THE
SE 1/4, SECTION 14, T20S R3W
MCIPHERSON COUNTY, KS.

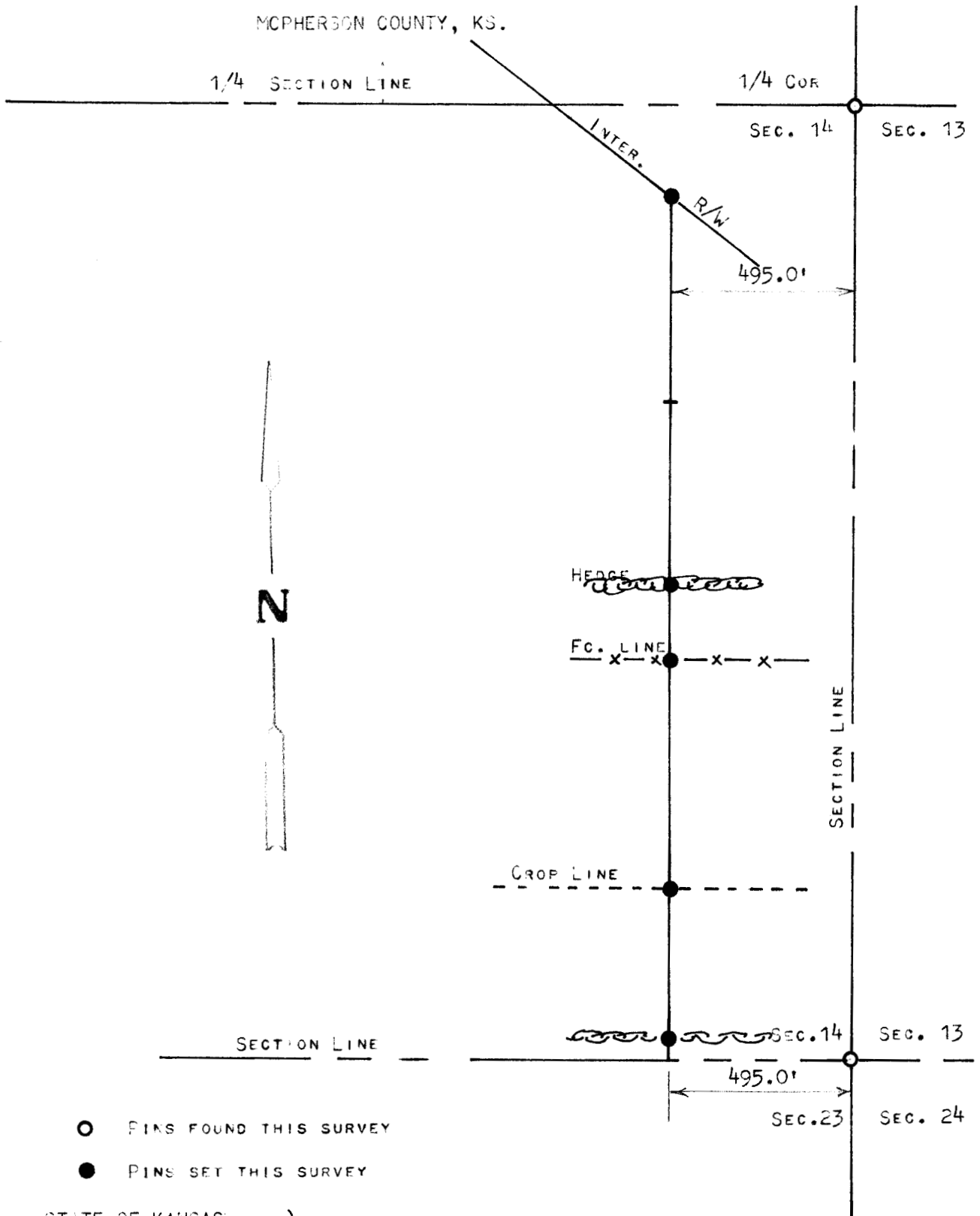

STATE OF KANSAS)
COUNTY OF MCIPHERSON) SS

I, FRANCIS RANKIN, PROFESSIONAL ENGINEER OF THE STATE OF KANSAS
DO HEREBY CERTIFY THAT UNDER MY SUPERVISION A SURVEY WAS MADE TO
DETERMINE A LINE 495.0 FEET WEST OF THE EAST SECTION LINE IN THE
SE 1/4, SECTION 14, T20S R3W OF THE 6TH P.M. AND THAT THE ACCOMPANYING
PLAT IS A TRUE EXHIBIT OF SAID SURVEY AS FAR AS IT IS KNOWN TO ME.

SURVEY CALLED FOR BY RAYMOND JUHNKE

SIGNED THIS 31 DAY OF AUGUST, 1970

FRANCIS RANKIN
PROFESSIONAL ENGINEER
MCIPHERSON, KANSAS
799

MICROFILM