

NW Cor. NE 1/4
Sec. 14, T19S, R2W
Fd. 1/2" Rebar
Origin: KSHS References by LS 1297 10/7/2003

4199.88 (M)

N 89°44'43" E 200.00 (M)(R)

N 01°16'56" W 1050.00 (M)(R)

1017.24 (W)

Existing Parcel
4.787 Acres

(Bk. 664, Pg. 750)

Shed

S 89°44'43" W
2.00 (M)(R)

ZONE X

Floodplain Line

HOUSE
NO. 2252
FF=1548.3

1553.9

1548.4

1555.2

1548.6

1548.4

1548.5

1548.6

1548.6

1548.6

1548.6

1548.6

1548.6

1548.6

1548.6

1548.6

1548.6

1548.6

1548.6

1548.6

1548.6

1548.6

1548.6

1548.6

1548.6

1548.6

1548.6

1548.6

1548.6

1548.6

1548.6

ZONE A

Fd. 1/2" Rebar w/PS 1297 Cap

33' R/W Line

S 89°44'43" W 198.00 (C)(R)

S 89°44'43" W 2665.31 (M)(PS)

MOCCASIN ROAD

SW Cor. SE 1/4

Sec. 14, T19S, R2W

Reset 5/8" Rebar w/Yellow GSS CLS 52 Cap

Origin: (PS)

SE Cor. SE 1/4
Sec. 14, T19S, R2W
Fd. 5/8" Rebar w/PS 1202
Origin: (PS)

2467.31 (M)

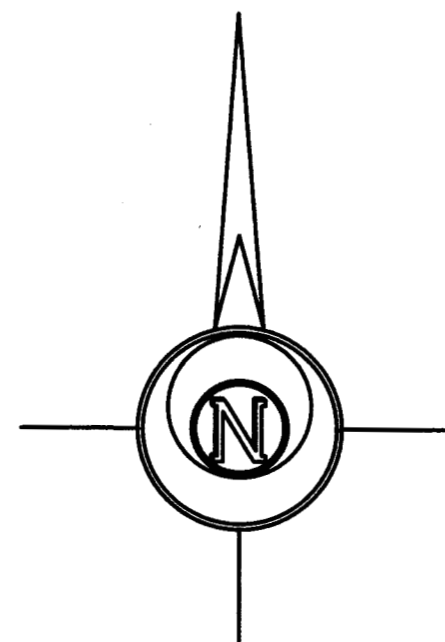

-60 0 60 120 180

BASIS OF BEARING = NAD 83 KANSAS SOUTH ZONE

LEGEND

- △ - Sectional Monument Found
- ▲ - Section Monument Set (5/8" x 24" Iron Rebar w/GSS CLS 52 Cap)
- - Survey Monument Found
- - 5/8" x 24" Iron Rebar Set w/GSS CLS 52 Cap
- (C) - Calculated
- (M) - Measured
- (PS) - Previous Survey GSS Project #G2017-794
- (R) - Record measurement

DESCRIPTION OF RECORD: (Bk. 664, Pg. 750)

A tract of land in the Southeast Quarter (SE/4), Section Fourteen (14), Township Nineteen (19), Range Two (2) West of the 6th Principle Meridian, McPherson County, Kansas, described as follows:

Commencing at the Southwest corner of said Southeast Quarter (SE/4) for the point of beginning thence North 1050 feet, thence East 200 feet, thence South 654 feet, thence West 2 feet, thence South 396 feet, thence West 198 feet to the point of beginning.

BASE FLOOD ELEVATION: 1547.0 (NAVD88)

ZONE: A

MAP PANEL 20113 C0245 E

NOTE: BFE is from Kansas Department of Agriculture Division of Water Resources

BENCHMARK:

1/2" Rebar with Red Cap.

Elevation=1554.55 (NAVD88)

SURVEYOR'S NOTE:

- Survey was made as per client request and no title work has been provided to the surveyor; therefore, the number and extent of easements and/or rights-of-way of record affecting said property has not been verified by this Survey.

SURVEYOR'S CERTIFICATE:

I hereby certify this plat to be a true, correct and complete representation of the property described hereon and the improvements and elevations thereon, as surveyed under my supervision, this 9th day of February, 2022.

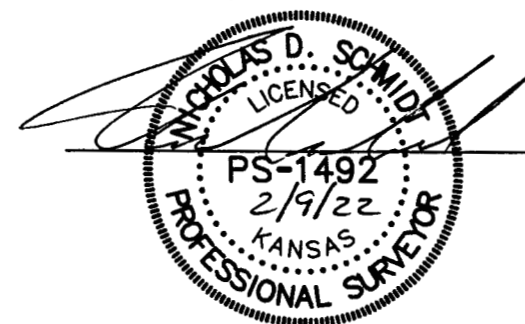

Prepared For:

MARK HOPPE

Description:

**A PORTION OF THE SE 1/4
SECTION 14, T19S, R2W
McPHERSON COUNTY, KANSAS**

Prepared By:

Garber Surveying Service, P.A.



HUTCHINSON
2908 North Plum St. 67502
Ph. 620-665-7032
(Main Office)

BRANCH OFFICES:
MANHATTAN Ph. 785-320-4810
MCPHERSON Ph. 620-241-4441
NEWTON Ph. 316-283-5053
SALINA Ph. 785-404-6302
WICHITA Ph. 316-260-9933

Drawn By: KDZ

Scale: 1"=60'

Date of Field Work: January 20, 2022

Job No:

Checked By: NDS

Date: 02/09/2022

Sheet 1 of 1 Sheet(s)

G2022-36