

BASIS OF BEARING = KANSAS STATE PLANE ZONE 1502

LEGEND

- △ - Sectional Monument Found
- - Fd. 5/8" Rebar w/GSS Cap
- - 5/8" x 24" Iron Rebar Set w/G.S.S. Cap
- (C) - Calculated
- (M) - Measured
- (PS) - Previous Survey - GSS Project #G13-645
- (R) - Record measurement
- P.O.B. - Point of Beginning
- P.O.C. - Point of Commencement

DESCRIPTION:

PARCEL 1

A portion of the Northwest Quarter of Section 13, Township 20 South, Range 3 West of the 6th Principal Meridian, McPherson County, Kansas described as follows:

Beginning at the Northwest corner of the Northwest Quarter of Section 13, Township 20 South, Range 3 West of the 6th Principal Meridian; thence on a Kansas State Plane Zone 1502 Bearing of North 88°39'31" East along the North line of said Northwest Quarter 2622.64 feet to the Northwest corner of a parcel of land described in Deed Book 174, Page 45 recorded at the McPherson County Register of Deeds Office, said corner being 114.18 feet (Record) West of the Northeast corner of said Northwest Quarter; thence South 01°24'59" East along the West line of said parcel 845.73 feet; thence South 88°39'31" West parallel with the North line of said Northwest Quarter 2631.00 feet to the West line of said Northwest Quarter; thence North 00°50'59" West along the West line of said Northwest Quarter 845.76 feet to the point of beginning, containing **51.000 Acres**, subject to road right of way easements across the West and North 33.00 feet thereof and any other easements or restrictions of record.

PARCEL 2

A portion of the Northwest Quarter of Section 13, Township 20 South, Range 3 West of the 6th Principal Meridian, McPherson County, Kansas described as follows:

Commencing at the Northwest corner of the Northwest Quarter of Section 13, Township 20 South, Range 3 West of the 6th Principal Meridian; thence on a Kansas State Plane Zone 1502 Bearing of South 00°50'59" East along the West line of said Northwest Quarter 845.76 feet to the point of beginning; thence North 88°39'31" East parallel with the North line of said Northwest Quarter 2631.00 feet to the West line of a parcel of land described in Deed Book 174, Page 45 recorded at the McPherson County Register of Deeds Office; thence South 01°24'59" East along the West line of said parcel 471.05 feet to the Southwest corner of said parcel, said corner being on the South line of the North Half of said Northwest Quarter; thence North 88°41'22" East along the South line of said parcel, also being the South line of said North Half, 85.14 feet (Record) to the Southeast corner of said North Half; thence South 00°09'11" East along the East line of said Northwest Quarter 1317.11 feet to the Southeast corner of said Northwest Quarter; thence South 88°43'15" West along the South line of said Northwest Quarter 2524.76 feet to a point 180.00 feet (Record) East of the Southwest corner of said Northwest Quarter; thence North 17°59'45" West 472.66 feet (472.60 Record); thence South 89°09'01" West perpendicular to the West line of said Northwest Quarter 40.65 feet to the West line of said Northwest Quarter; thence North 00°50'59" West along the West line of said Northwest Quarter 1322.05 feet to the point of beginning containing **109.250 Acres**, subject to a road right of way easement across the West 33.00 feet thereof and any other easements or restrictions of record.

SURVEYOR'S CERTIFICATE:

I hereby certify this plat to be a true, correct and complete representation of the property described hereon, as surveyed under my supervision, this 28th day of February, 2014.

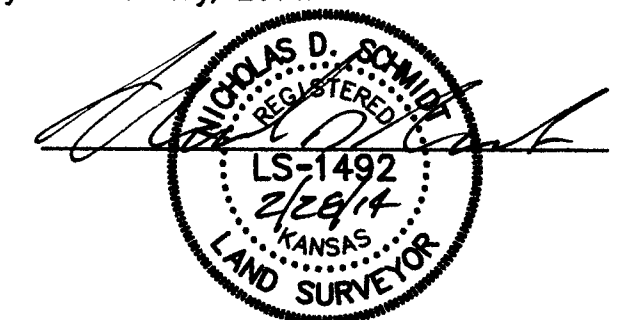

Prepared For: AGGIE REICHERT		Description: PORTIONS OF THE NW 1/4 SECTION 13, T20S, R3W MCPHERSON COUNTY, KANSAS	
Prepared By: GSS		Garber Surveying Service, P.A.	
HUTCHINSON (Main Office) 2908 North Plum St. 67502 Ph. 620-665-7032 Fax 620-663-7401 MCPHERSON (Branch Office) 115 East Marlin 67460 Ph. 620-241-4441 Fax 620-241-4458 NEWTON (Branch Office) 511 North Poplar St. 67114 Ph. 316-283-5053 Fax 316-283-5073			
Drawn By: CSS	Scale: 1"=300'	Date of Field Work: February 27, 2014	Job No:
Checked By: NDS	Date: 2/28/2014	Sheet 1 of 1 Sheet(s)	G2014-122

