

CENTERLINE TURKEY CREEK		
(1)	S 09°34'01" E	77.39 (M)
(2)	S 17°50'08" W	142.81 (M)
(3)	S 69°46'57" W	46.90 (M)
(4)	S 26°25'35" W	394.74 (M)
(5)	S 39°26'01" W	152.07 (M)
(6)	S 17°03'58" E	417.65 (M)
(7)	S 38°55'45" E	181.33 (M)
(8)	S 08°43'22" W	531.49 (M)
(9)	S 59°29'47" W	250.10 (M)
(10)	S 78°17'36" W	352.90 (M)

DESCRIPTION:

PARCEL 1:

A portion of the Southwest Quarter of Section 13, Township 20 South, Range 3 West of the 6th Principal Meridian, McPherson County, Kansas described as follows:

Commencing at the Northwest corner of said Southwest Quarter; thence on a NAD 83 Kansas South Zone bearing of North 88°43'15" East on the North line of said Southwest Quarter a distance of 180.00 feet (Record) to the Easterly Right of Way line of Interstate Highway 135, being the point of beginning; thence continuing North 88°43'15" East on said North line a distance of 2217.65 feet to the centerline of Turkey Creek; thence along said centerline for the next 10 courses:
South 09°34'01" E a distance of 77.39 feet;
South 17°50'08" West a distance of 142.81 feet;
South 69°46'57" West a distance of 46.90 feet;
South 26°25'35" West a distance of 394.74 feet;
South 39°26'01" West a distance of 152.07 feet;
South 17°03'58" East a distance of 417.65 feet;
South 38°55'45" East a distance of 181.33 feet;
South 08°43'22" West a distance of 531.49 feet;
South 59°29'47" West a distance of 250.10 feet;
South 78°17'36" West a distance of 352.90 feet to said Right of Way; thence along said Right of Way for the next 6 courses:
North 42°58'16" West a distance of 634.71 feet;
North 47°58'17" West a distance of 224.30 feet;
North 42°54'07" West a distance of 882.33 feet;
North 88°44'58" East a distance of 40.10 feet;
North 42°07'54" West a distance of 447.35 feet;
North 00°52'32" West a distance of 320.62 feet to the point of beginning.

Containing 63.541 Acres and subject to any easements or restrictions of record.

PARCEL 2:

A portion of the Southwest Quarter of Section 13, Township 20 South, Range 3 West of the 6th Principal Meridian, McPherson County, Kansas described as follows:

Beginning at the Southeast corner of said Southwest Quarter; thence on a NAD 83 Kansas South Zone bearing of South 88°50'13" West on the South line of said Southwest Quarter a distance of 433.70 feet to the Easterly Right of Way line of Interstate Highway 135; thence North 42°58'16" West on said Right of Way a distance of 928.32 feet to the centerline of Turkey Creek; thence along said centerline of the next 10 courses:
North 78°17'36" East a distance of 352.90 feet;
North 59°29'47" East a distance of 250.10 feet;
North 08°43'22" East a distance of 531.49 feet;
North 38°55'45" West a distance of 181.33 feet;
North 17°03'58" West a distance of 417.65 feet;
North 39°26'01" East a distance of 152.07 feet;
North 26°25'35" East a distance of 394.74 feet;
North 69°46'57" East a distance of 46.90 feet;
North 17°50'08" East a distance of 142.81 feet;
North 9°34'01" West a distance of 77.39 feet to the North line of said Southwest Quarter; thence North 88°43'15" East a distance of 307.11 feet to the Northeast corner of said Southwest Quarter; thence South 00°09'11" East a distance of 2640.94 feet to the point of beginning.

Containing 34.592 Acres and subject to a road right of easement across the South 33.00 feet thereof and any other easements or restrictions of record.

SURVEYOR'S CERTIFICATE:

I hereby certify this plat to be a true, correct and complete representation of the property described hereon, as surveyed under my supervision, this 18th day of June, 2018.

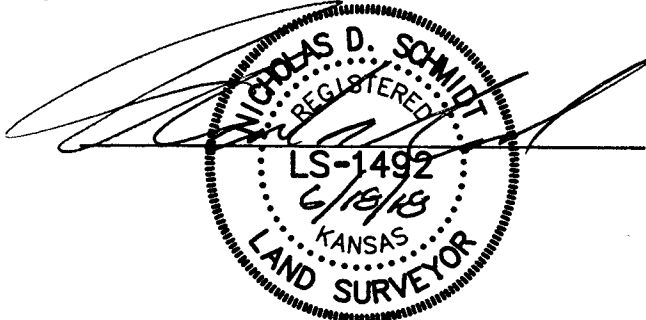

Prepared For:		Description:	
FOSTER		A PORTION OF THE SW 1/4 SECTION 13, T20S, R3W MCPHERSON COUNTY KANSAS	
Prepared By:		Garber Surveying Service, P.A.	
GSS		HUTCHINSON (Main Office) 2908 North Plum St. 67502 Ph. 620-665-7032 Fax 620-663-7401 MCPHERSON (Branch Office) 115 East Marlin 67460 Ph. 620-241-4441 Fax 620-241-4458 NEWTON (Branch Office) 511 North Poplar St. 67114 Ph. 316-283-5053 Fax 316-283-5073	
Drawn By:	KDZ	Scale: 1"=200'	Date of Field Work: June 5, 2018
Checked By:	NDS	Date: 06/18/2018	Sheet 1 of 1 Sheet(s)
			Job No: G2018-420