

Copyright © 2020 Garber Surveying Service, P.A. Saved 8/31/2021 11:48:04 AM by KZOOK
Plot Date & Time Tuesday, August 31, 2021 11:48:23 AM Dwg Path E:\LDD\GSSFILES\2021\20210778M.dwg\20210778M.dwg Client Adjusted 2021-08-24

FRONTIER ROAD

N 88°38'47" E 2662.31 (M) 2662.03 (PS)

NW Cor. NE 1/4
Sec. 12, T20S, R5W
Fd. 5/8" Rebar w/LS 1202 Cap
Origin: County References by
TRC Pipeline Services, LLC 8/2019

NE Cor. NE 1/4
Sec. 12, T20S, R5W
Fd. 5/8" Rebar
Origin: County References by
TRC Pipeline Services, LLC 6/1/2019

N 1/2, NE 1/4

S 00°03'21" E 1321.25 (M) 1322.21 (PS)

NW Cor. SW 1/4, NE 1/4
Sec. 12, T20S, R5W
Fd. 5/8" Rebar w/LS 1202 Cap
Origin: KSHS References by LS 1202 12/15/2010

NW Cor. SE 1/4, NE 1/4
Sec. 12, T20S, R5W
Fd. 5/8" Rebar w/LS 1202 Cap
Origin: Unknown

NE Cor. SE 1/4, NE 1/4
Sec. 12, T20S, R5W
Calculated Location
(Falls in Trees)

Fd. 1/2" Rebar w/LS 1202 Cap

N 88°43'06" E 1331.69 (C) 1331.75 (PS)

N 88°39'39" E 1331.41 (C) 1331.38 (PS)
1298.59 (M)

N 88°43'06" E 761.75 (M)

569.95 (M)

32.82 (C)

S 00°40'47" W
414.58 (M)

S 382.95 (M)
N 88°47'01" E

N 72°22'22" E
356.00 (M)

N 88°22'09" E 1184.60 (C)
1151.59 (M)

33.01 (C)

N 00°04'10" W 1323.45 (M) 1322.20 (PS)

SW Cor. NW 1/4
Sec. 12, T20S, R5W
Fd. 1/2" Pipe
Origin: County References
by LS 1202 12/15/2010

Witness Monument
5.0' W of corner

S 88°42'09" W

2660.40 (M) 2660.11 (PS)

SW Cor. NE 1/4
Sec. 12, T20S, R5W
(Calculated Location, Falls in Trees)

N 00°03'45" W
2645.78 (M) 2645.58 (PS)

SW Cor. SE 1/4
Sec. 12, T20S, R5W
Fd. 1/2" Rebar
Origin: County References by
TRC Pipeline Services, LLC 8/2019

SURVEYOR'S NOTE:

- Survey was made as per client request and no title work has been provided to the surveyor; therefore, the number and extent of easements and/or rights-of-way of record affecting said property has not been verified by this Survey.

SE Cor. NE 1/4
Sec. 12, T20S, R5W
Fd. 5/8" Rebar w/LS 1202 Cap
Origin: County References by
TRC Pipeline Services, LLC 8/2019

33.01 (M)

P.O.B.

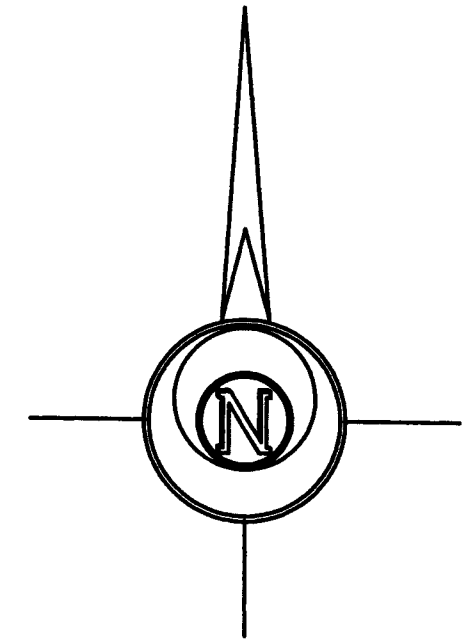

-200 0 200 400 600

BASIS OF BEARING = NAD 83 KANSAS SOUTH ZONE

LEGEND

- △ - Sectional Monument Found
- - Survey Monument Found
- - 5/8" x 24" Iron Rebar Set w/GSS CLS 52 Cap
- (C) - Calculated
- (M) - Measured
- (PS) - Previous Survey by LS 1202 12/8/2010
- P.O.B. - Point of Beginning

DESCRIPTION:

A portion of the South Half of the Northeast Quarter of Section 12, Township 20 South, Range 5 West of the 6th Principal Meridian, McPherson County, Kansas described as follows:

Beginning at the Southeast corner of said Northeast Quarter; thence on a NAD 83 Kansas South Zone bearing of South 88°42'09" West on the South line of said Northeast Quarter a distance of 2663.62 feet to the Southwest corner of said Northeast Quarter; thence North 00°04'10" West on the West line of said Northeast Quarter a distance of 1323.45 feet to the Northwest corner of said South Half of the Northeast Quarter; thence North 88°43'06" East on the North line of said South Half of the Northeast Quarter a distance of 761.75 feet; thence South 00°40'47" West a distance of 414.58 feet; thence North 88°47'01" East a distance of 382.95 feet; thence North 72°22'22" East a distance of 356.00 feet; thence North 88°22'09" East a distance of 1184.60 feet to the East line of said Northeast Quarter; thence South 00°05'32" East on said East line a distance of 1015.27 feet to the point of beginning.

Containing **65.96 Acres** and subject to a road right of way easement along the East line thereof, and any other easements or restrictions of record.

SURVEYOR'S CERTIFICATE:

I hereby certify this plat to be a true, correct and complete representation of the property described hereon, as surveyed under my supervision, this 31st day of August, 2021.

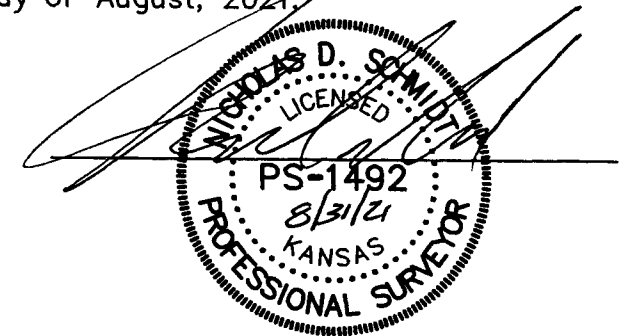

Prepared For:

TONY WIEBE

Description:

**A PORTION OF THE NE 1/4
SECTION 12, T20S, R5W
McPHERSON COUNTY, KANSAS**

Prepared By:

Garber Surveying Service, P.A.



HUTCHINSON
2908 North Plum St. 67502
Ph. 620-665-7032
(Main Office)

BRANCH OFFICES:
MANHATTAN Ph. 785-320-4810
MCPHERSON Ph. 620-241-4441
NEWTON Ph. 316-283-5053
SALINA Ph. 785-404-6302
WICHITA Ph. 316-260-9933

Drawn By:

KDZ

Scale: 1"=200'

Date of Field Work: July 13, 2021

Job No:

Checked By:

NDS

Date: 08/31/2021

Sheet 1 of 1 Sheet(s)

G2021-778