

- LEGEND
- △ - Sectional Monument Found
 - ▲ - Section Monument Set (5/8" x 24" Iron Rebar w/GSS CLS 52 Cap)
 - - 5/8" x 24" Iron Rebar Set w/GSS CLS 52 Cap
 - × - Calculated Location
 - (C) - Calculated
 - (M) - Measured
 - (PS) - Previous Survey by Joshua Leonard, 5/6/1879
 - (GLO) - General Land Office

DESCRIPTIONS:

TRACT 1

The Northwest Quarter of the Northeast Quarter of Section 12, Township 19 South, Range 2 West of the 6th Principal Meridian, McPherson County, Kansas.

Containing 40.31 Acres and subject to a road right of way easement along the North line thereof, and any other easements or restrictions of record.

TRACT 2

The Northeast Quarter Section 12, Township 19 South, Range 2 West of the 6th Principal Meridian, McPherson County, Kansas EXCEPT the Northwest Quarter of the Northeast Quarter of Section 12, Township 19 South, Range 2 West of the 6th Principal Meridian, McPherson County, Kansas.

Containing 121.09 Acres and subject to road right of way easements along the North and East line thereof, and any other easements or restrictions of record.

SURVEYOR'S CERTIFICATE:

I hereby certify this plat to be a true, correct and complete representation of the property described hereon, as surveyed under my supervision, this 4th day of December, 2023.

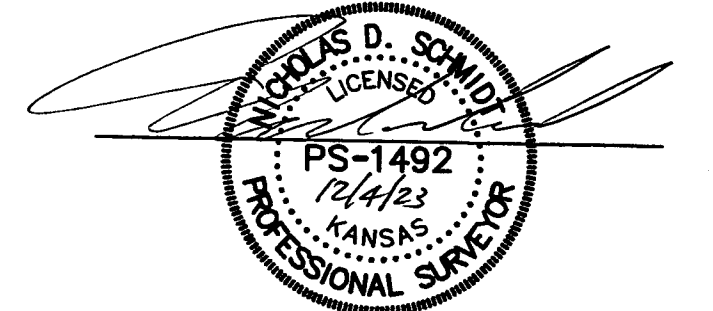

SURVEYOR'S NOTES:

- Survey was made as per client request and no title work has been provided to the surveyor; therefore, the number and extent of easements and/or rights-of-way of record affecting said property has not been verified by this Survey.
- All measurements are in US Survey Feet.

Prepared For:	Description: THE NE 1/4 SECTION 12, T19S, R2W McPHERSON COUNTY, KANSAS		
Prepared By:	Garber Surveying Service, P.A.		
HUTCHINSON 2908 North Plum St. 67502 Ph. 620-665-7032 (Main Office)			
BRANCH OFFICES:		MANHATTAN Ph. 785-320-4810	NEWTON Ph. 316-283-5053
		SALINA Ph. 785-404-6302	WICHITA Ph. 316-260-9933
Drawn By:	KDZ	Scale: 1"=200'	Date of Field Work: September 14, 2023
Checked By:	NDS	Date: 12/04/2023	Sheet 1 of 1 Sheet(s)
			Job No: G2023-739