

- LEGEND
- △ - Sectional Monument Found
  - ▲ - Section Monument Set (5/8" x 24" Iron Rebar w/G.S.S. Cap)
  - - 5/8" x 24" Iron Rebar Set w/G.S.S. Cap
  - ⊕ - Power Pole
  - CHE - Overhead Electric Line
  - (C) - Calculated
  - (M) - Measured
  - (PS) - Previous Survey GSS Project #G2003-134
  - P.O.B. - Point of Beginning
  - P.O.C. - Point of Commencement

DESCRIPTIONS:

PARCEL 1

A portion of the West Half of the Northeast Quarter and the North Half of the Northwest Quarter of Section 11, Township 19 South, Range 5 West of the 6th Principal Meridian, McPherson County, Kansas described as follows:

Beginning at the Northwest corner of said Northeast Quarter; thence on a NAD 83 Kansas South Zone bearing of North 89°19'06" East on the North line of said Northeast Quarter a distance of 117.90 feet; thence South 02°05'01" East a distance of 388.46 feet; thence North 87°22'12" East a distance of 157.52 feet; thence South 08°32'01" East a distance of 259.50 feet; thence South 31°01'52" West a distance of 93.89 feet; thence South 00°23'48" West a distance of 165.61 feet; thence South 89°33'10" East a distance of 587.24 feet; thence North 01°41'48" West a distance of 338.71 feet; thence South 89°47'56" East a distance of 419.13 feet to a point 50.00 feet West of the East line of the West Half of said Northeast Quarter; thence South 00°19'37" East parallel with said East line a distance of 1262.99 feet; thence South 89°02'31" West a distance of 1270.43 feet to the West line of said Northeast Quarter; thence North 00°21'44" West on said West line a distance of 1402.00 feet; thence South 89°38'16" West perpendicular to the East line of said Northwest Quarter a distance of 32.00 feet; thence North 00°21'44" West parallel with said East line distance of 431.82 feet to the North line of said Northwest Quarter; thence North 89°18'28" East on said North line a distance of 32.00 feet to the point of beginning.

Containing **35.374 Acres** and subject to a road right of way easement across the North 33.00 feet thereof and any other easements or restrictions of record.

PARCEL 2

A portion of the West Half of the Northeast Quarter f Section 11, Township 19 South, Range 5 West of the 6th Principal Meridian, McPherson County, Kansas described as follows:

Commencing at the Northwest corner of said Northeast Quarter; thence on a NAD 83 Kansas South Zone bearing of North 89°19'06" East on the North line of said Northeast Quarter a distance of 117.90 feet to the point of beginning; thence continuing North 89°19'06" East on said North line a distance of 1203.61 feet to the Northeast corner of the West Half of said Northeast Quarter; thence South 00°19'37" East on the East line of said West Half a distance of 2648.74 feet to the Southeast corner of said West Half; thence South 89°24'45" West on the South line of said Northeast Quarter a distance of 1319.87 feet to the Southwest corner of said Northeast Quarter; thence North 00°21'44" West on the West line of said Northeast Quarter a distance of 812.56 feet; thence North 89°02'31" East a distance of 1270.43 feet to a point 50.00 feet West of the East line of said West Half; thence North 00°19'37" West parallel with said East line a distance of 1262.99 feet; thence North 89°47'56" West a distance of 419.13 feet; thence South 01°41'48" East a distance of 338.71 feet; thence North 89°33'10" West a distance of 587.24 feet; thence North 00°23'48" East a distance of 165.61 feet; thence North 31°01'52" East a distance of 93.89 feet; thence North 08°32'01" West a distance of 259.50 feet; thence South 87°22'12" West a distance of 157.52 feet; thence North 02°05'01" West a distance of 388.46 feet to the point of beginning.

Containing **45.216 Acres** and subject to a road right of way easement across the North 33.00 feet thereof and any other easements or restrictions of record.

PARCEL 3

A portion of the North Half of the Northwest Quarter of Section 11, Township 19 South, Range 5 West of the 6th Principal Meridian, McPherson County, Kansas described as follows:

Beginning at the Northwest corner of said Northwest Quarter; thence on a NAD 83 Kansas South Zone bearing of North 89°18'28" East on the North line of said Northwest Quarter a distance of 2610.79 feet to a point 32.00 feet West of the Northeast corner of said Northwest Quarter; thence South 00°21'44" East parallel with the East line of said Northwest Quarter a distance of 431.82 feet; thence North 89°38'16" East perpendicular to said East line a distance of 32.00 feet to said East line; thence South 00°21'44" East on said East line a distance of 891.28 feet to the Southeast corner of the North Half of said Northwest Quarter; thence South 89°21'13" West on the South line of said North Half a distance of 2644.86 feet to the Southwest Quarter of said North Half; thence North 00°16'18" West on the West line of said Northwest Quarter a distance of 1321.18 feet to the point of beginning.

Containing **79.932 Acres** and subject to road right of way easements across the North and West 33.00 feet thereof and any other easements or restrictions of record.

SURVEYOR'S CERTIFICATE:

I hereby certify this plat to be a true, correct and complete representation of the property described hereon, as surveyed under my supervision, this 17th day of March, 2017.

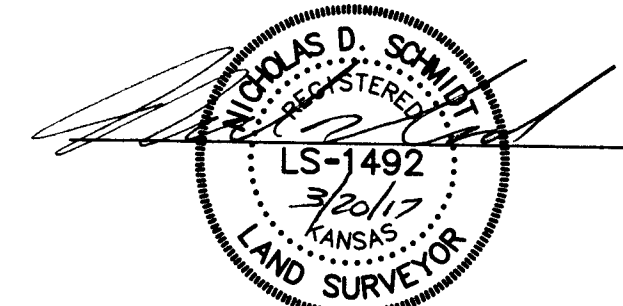

Prepared For:		Description:	
JANEY BAILEY		A PORTION OF SECTION 11, T19S, R05W McPHERSON COUNTY, KANSAS	
Prepared By:		Garber Surveying Service, P.A.	
GSS		HUTCHINSON (Main Office) 2908 North Plum St. 67502 Ph. 620-665-7032 Fax 620-663-7401	
		McPHERSON (Branch Office) 115 East Main 67449 Ph. 620-241-4441 Fax 620-241-4458	
		NEWTON (Branch Office) 511 North Poplar St. 67114 Ph. 316-283-5053 Fax 316-283-5073	
Drawn By:	RLE	Scale: 1" = 200'	Date of Field Work: March 3, 2017
Checked By:	NDS	Date: 03/17/2017	Sheet 1 of 1 Sheet(s)
			Job No: G2017-121