

- LEGEND**
- △ - Sectional Monument Found
 - - Fd. 5/8" Rebar from (PS)
 - - 5/8" x 24" Iron Rebar Set w/G.S.S. Cap
 - (C) - Calculated
 - (M) - Measured
 - (PS) - Previous Survey by LS 88-1985
 - (PS1) - Previous Survey by LS 1412 6/23/2012
 - (PS2) - Previous Survey GSS Project #62000-351
 - (R) - Record measurement

DESCRIPTION:
A portion of the Southwest Quarter of Section 11, Township 19 South, Range 3 West of the 6th Principal Meridian, McPherson County, Kansas described as follows:

Commencing at the Southwest corner of the East Half of said Southwest Quarter; thence on a NAD 83 Kansas South Zone bearing of North 00°43'06" West on the West line of said East Half a distance of 867.50 feet (Record) to the Southwest corner of a parcel described in Deed Book 256, Page 301 recorded at the McPherson County Register of Deeds Office, also being the point of beginning; thence continuing North 00°43'06" West on said West line and the West line of said parcel a distance of 392.28 feet; thence North 88°50'44" East a distance of 259.33 feet; thence North 07°13'28" West a distance of 105.00 feet; thence North 88°50'44" East a distance of 318.00 feet; thence South 00°01'45" East a distance of 189.50 feet; thence South 88°50'44" West a distance of 40.00 feet; thence South 01°26'53" East a distance of 310.73 feet to the South line of a parcel described in Deed Book 256, Page 551 recorded at the McPherson County Register of Deeds Office; thence South 88°50'44" West on said South line a distance of 365.99 feet; thence North 89°54'11" West on the South line of said parcel described in Deed Book 256, Page 301 a distance of 161.13 feet (Record) to the point of beginning.

Containing **5.587 Acres** and subject to any easements or restrictions of record.

PROPOSED 20' INGRESS-EGRESS EASEMENT

A 20.00 foot wide ingress-egress easement, the centerline of which is described as follows:

Commencing at the Southwest corner of the East Half of said Southwest Quarter of Section 11, Township 19 South, Range 3 West of the 6th Principal Meridian, McPherson County, Kansas; thence on a NAD 83 Kansas South Zone bearing of North 89°00'24" East on the South line of said Southwest Quarter a distance of 538.08 feet; thence North 01°26'43" West a distance of 865.48 feet to the point of beginning; thence North 01°26'53" West a distance of 310.73 feet to the point of termination.

SURVEYOR'S CERTIFICATE:
I hereby certify this plot to be a true, correct and complete representation of the property described hereon, as surveyed under my supervision, this 24th day of May, 2016.

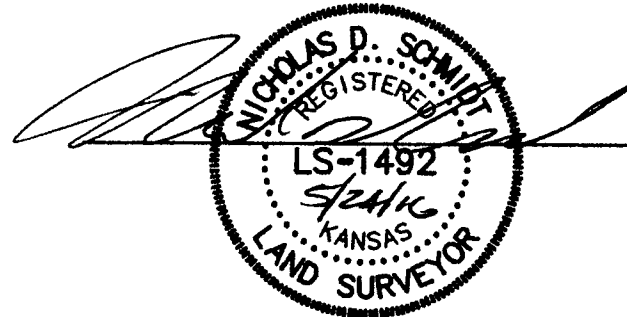

Prepared For: KREHBIEL PROPERTIES		Description: A PORTION OF THE SW 1/4 SECTION 11, T19S, R3W McPHERSON COUNTY, KANSAS	
Prepared By: GSS		Garber Surveying Service, P.A.	
HUTCHINSON (Main Office) 2908 North Plum St. 67502 Ph. 620-665-7032 Fax 620-663-7401		McPHERSON (Branch Office) 115 East Marlin 67460 Ph. 620-241-4441 Fax 620-241-4458	
NEWTON (Branch Office) 511 North Poplar St. 67114 Ph. 316-283-5053 Fax 316-283-5073			
Drawn By: KLL	Scale: 1"=40'	Date of Field Work: May 18, 2016, 2016	Job No: G2016-314
Checked By: NDS	Date: 05/24/2016	Sheet 1 of 1 Sheet(s)	