

-200 0 200 400 600

BASIS OF BEARING = NAD 83 KANSAS SOUTH ZONE

LEGEND

- △ - Sectional Monument Found
- ▲ - Section Monument Set (5/8" x 24" Iron Rebar w/GSS CLS 52 Cap)
- - 5/8" x 24" Iron Rebar Set w/GSS CLS 52 Cap
- (C) - Calculated
- (M) - Measured
- (PS) - Previous Survey by LS 697 8/21/1987
- X— Existing Fence Line
- - - Proposed Fence Line

DESCRIPTION:

The East Half of the Southeast Quarter of Section 11, Township 18 South, Range 1 West of the 6th Principal Meridian, McPherson County, Kansas.

SURVEYOR'S NOTE:

- Survey was made as per client request and no title work has been provided to the surveyor; therefore, the number and extent of easements and/or rights-of-way of record affecting said property has not been verified by this Survey.
- Total Acreage = 76.90 Acres.
- Total Paddock Acreage = 66.84 Acres.
- Total Paddock Fence Required = 16,108 Feet.

SURVEYOR'S CERTIFICATE:

I hereby certify this plat to be a true, correct and complete representation of the property described hereon, as surveyed under my supervision, this 28th day of February, 2023.

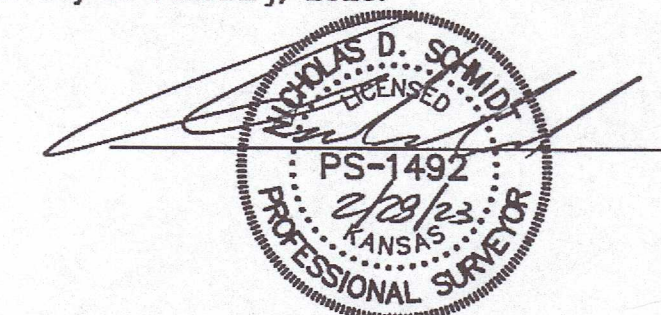

Prepared For:		Description:	
NELSON WIEBE		THE E 1/2 SE 1/4 SECTION 11, T18S, R1W McPHERSON COUNTY, KANSAS	
Prepared By:		Garber Surveying Service, P.A.	
 HUTCHINSON 2908 North Plum St. 67502 Ph. 620-665-7032 (Main Office)		BRANCH OFFICES: MANHATTAN Ph. 785-320-4810 MCPHERSON Ph. 620-241-4441 NEWTON Ph. 316-283-5053 SALINA Ph. 785-404-6302 WICHITA Ph. 316-260-9933	
Drawn By: KDZ	Scale: 1"=200'	Date of Field Work: January 17, 2023	Job No:
Checked By: NDS	Date: 02/28/2023	Sheet 1 of 1 Sheet(s)	G2023-38