

LEGEND

- △ - Sectional Monument Found
- - Fd. 5/8" Rebar w/LS 697 Cap (PS)
- Unless Otherwise Noted
- - 5/8" x 24" Iron Rebar Set w/GSS CLS 52 Cap
- (C) - Calculated
- (M) - Measured
- (PS) - Previous Survey by LS 697, 10/22/1999
- (PS1) - Previous Survey GSS Project #G2013-49
- P.O.B. - Point of Beginning

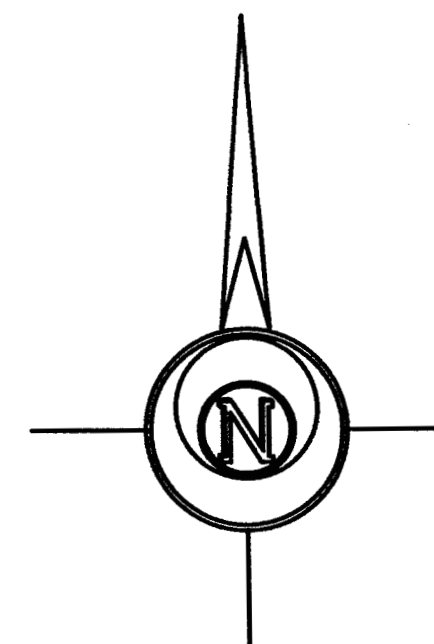

-300 0 300 600 900

BASIS OF BEARING = NAD 83 KANSAS SOUTH ZONE

DESCRIPTION:

A portion of the Southeast Quarter of Section 10, Township 18 South, Range 3 West of the 6th Principal Meridian, McPherson County, Kansas, described as follows by Nicholas D. Schmidt, PS #1492, this 21st day of December, 2023:

Beginning at the Southwest corner of said Southeast Quarter; thence on a NAD 83 Kansas South Zone bearing of North 00°30'36" West on the West line of said Southeast Quarter a distance of 2636.56 feet to the Northwest corner of said Southeast Quarter; thence South 89°14'24" East on the North line of said Southeast Quarter a distance of 1053.48 feet to the Northwest corner of a parcel described in Book 247, Page 912 at the McPherson County Register of Deeds Office; thence South 00°22'51" East on the West line of said parcel a distance of 1069.90 feet to the Southwest corner of said parcel; thence South 88°12'22" East on the South line of said parcel a distance of 63.02 feet; thence South 00°22'42" East parallel with the East line of said Southeast Quarter a distance of 1567.96 feet to the South line of said Southeast Quarter; thence North 89°06'27" West on said South line a distance of 1110.51 feet to the point of beginning.

The above described tract contains **65.86 Acres** and is subject to a road right of way easement along the South line thereof, and any other easements or restrictions of record.

SURVEYOR'S CERTIFICATE:

I hereby certify this plat to be a true, correct and complete representation of the property described hereon, as surveyed under my supervision, this 21st day of December, 2023.

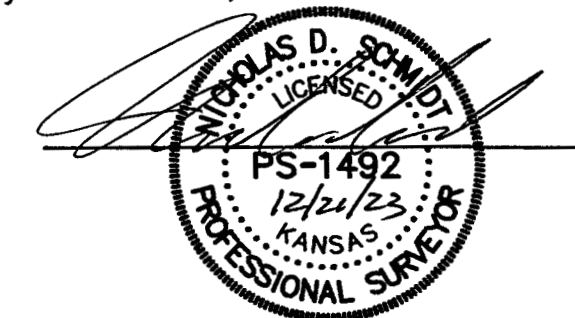

SURVEYOR'S NOTES:

- Survey was made as per client request and no title work has been provided to the surveyor; therefore, the number and extent of easements and/or rights-of-way of record affecting said property has not been verified by this Survey.
- All measurements are in US Survey Feet.

Prepared For:	TANNER LOTT			Description:	A PORTION OF THE SE 1/4 SECTION 10, T18S, R3W MCPHERSON COUNTY, KANSAS		
Prepared By:	Garber Surveying Service, P.A.						
		HUTCHINSON 2908 North Plum St. 67502 Ph. 620-665-7032 (Main Office)		BRANCH OFFICES:		MANHATTAN Ph. 785-320-4810 NEWTON Ph. 316-283-5053 WICHITA Ph. 316-260-9933	
Drawn By:	KDZ	Scale:	1"=300'	Date of Field Work:	December 18, 2023	Job No:	G2023-957
Checked By:	NDS	Date:	12/21/2023	Sheet	1 of 1 Sheet(s)		