

LEGEND

- △ - Sectional Monument Found
- - 5/8" x 24" Iron Rebar Set w/G.S.S. Cap
- ✕ - Fence
- ⊕ - Power Pole
- (C) - Calculated
- (M) - Measured
- (PS) - Previous Survey GSS Project #G2004-549
- P.O.B. - Point of Beginning
- P.O.C. - Point of Commencement

SURVEYOR'S NOTES:

- Survey was made as per client request and no title work has been provided to the surveyor; therefore, the number and extent of easements and/or rights-of-way of record affecting said property has not been verified by this Survey.
- Origin of found monuments unknown unless noted.

DESCRIPTION:

A portion of the Southeast Quarter of Section 1, Township 21 South, Range 2 West of the 6th Principal Meridian, McPherson County, Kansas, described as follows by Nicholas D. Schmidt, PS #1492, this 3rd day of December, 2021:

Commencing at the Southeast corner of said Southeast Quarter; thence on a NAD 83 Kansas South Zone bearing of North 00°15'26" West on the East line of said Southeast Quarter a distance of 941.08 feet to the point of beginning; thence South 89°44'34" West perpendicular to said East line a distance of 244.99 feet; thence North 00°15'26" West parallel with said East line a distance of 137.27 feet; thence South 89°44'34" West perpendicular to said East line a distance of 315.93 feet; thence North 00°15'26" West parallel with said East line a distance of 245.80 feet; thence North 89°44'34" East perpendicular to said East line a distance of 130.63 feet; thence North 00°15'26" West parallel with said East line a distance of 217.52 feet; thence East 89°44'34" East perpendicular to said East line a distance of 430.29 feet to said East line; thence South 00°15'26" East on said East line a distance of 600.58 feet to the point of beginning.

Containing 6.09 Acres and subject to a road right of way easement along the East line thereof, and any other easements or restrictions of record.

SURVEYOR'S CERTIFICATE:

I hereby certify this plat to be a true, correct and complete representation of the property described hereon, as surveyed under my supervision, this 3rd day of December, 2021.

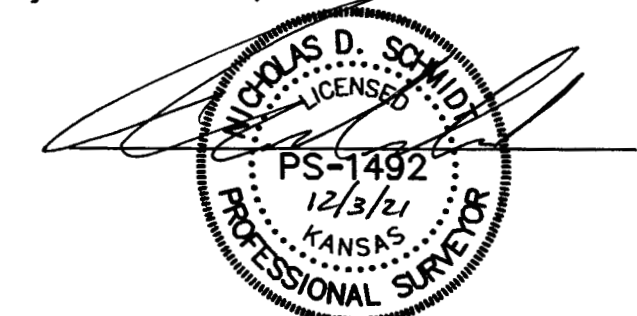

Prepared For: MID-KANSAS CREDIT UNION		Description: A PORTION OF THE SE 1/4 SECTION 1, T21S, R2W McPHERSON COUNTY, KANSAS	
Prepared By: GSS HUTCHINSON 2908 North Plum St. 67502 Ph. 620-665-7032 (Main Office)		Garber Surveying Service, P.A. BRANCH OFFICES: MCPHERSON Ph. 620-241-4441 SALINA Ph. 785-404-6302 MANHATTAN Ph. 785-320-4810 NEWTON Ph. 316-283-5053 WICHITA Ph. 316-260-9933	
Drawn By: GAQ	Scale: 1"=50'	Date of Field Work: November 17, 2021	Job No:
Checked By: NDS	Date: 12/03/2021	Sheet 1 of 1 Sheet(s)	G2021-1182